

ZONE "DD"

60002020378  
WC-Kenwood LLC

60002020268  
HME Kenwood LLC

ZONE "OO"

60002021269  
JRE Real Estate LLC

60000940009  
The Myers Y. Cooper  
Company

ZONE "OO"

ZONE "OO"

60002100870  
SMC Kenwood LLC

HOLIDAY ACRES  
SUBDIVISION BLOCK "C" 60  
P.B. 109 PG. 13-14  
60002100792  
Vernon & Wilma Jean  
Sennett

59 60002100791  
Joseph A. Jr. &  
Christina L. Martini

60002100790  
Thomas E. & Donna S.  
Davin

ZONE "B"

60002100789  
Charles J. &  
Carrol Donovan

56 60002100788  
Ronald J. & Jo Ann  
Smith

55 60002100787  
Samuel E. R.  
Smith

54 60002100786  
Thomas P. Kronenberger

60002100785  
Juanita C. Ehiman

53 HOLIDAY ACRES  
SUBDIVISION BLOCK "C"  
P.B. 109 PG. 13-14

60002100691  
Jean A. Brensen  
SUBDIVISION BLOCK "B"  
P.B. 84 PG. 88

60002100690  
Anna McGahan & Sheryl  
Martin

HOLIDAY ACRES  
SUBDIVISION BLOCK "B"  
P.B. 84 PG. 88  
39  
60002100678  
Virginia E. Bucher

40  
60002100679  
Darlene Payne

41  
60002100680  
Donald H. Baltzer

HOLIDAY ACRES  
SUBDIVISION BLOCK "B"  
P.B. 84 PG. 88  
18  
60002100676  
Kenneth Larue  
Mathys & Laura Lea  
Gardner, TR

HOLIDAY ACRES  
SUBDIVISION BLOCK "E" 18  
P.B. 89 PG. 30  
60002100707  
Gary Stiffer, TR

HOLIDAY ACRES  
SUBDIVISION BLOCK "E" 19  
P.B. 89 PG. 30  
60002100708  
Edward J. Fisher, TR

HAPPINESS WAY (50' R/W)

HOLIDAY ACRES 60002100677  
SUBDIVISION BLOCK "E" 29  
P.B. 84 PG. 88  
Kenwood Valley Holdings,  
LLC

ZONE "D"

HOLIDAY ACRES  
SUBDIVISION BLOCK "E" 29  
P.B. 89 PG. 30  
60002100718  
Kenwood Valley Holdings,  
LLC

HOLIDAY ACRES  
SUBDIVISION BLOCK "E" 28  
P.B. 89 PG. 30  
60002100717  
Lauren E. Sipple, TR

HOLIDAY ACRES 8  
SUBDIVISION BLOCK "A"  
P.B. 84 PG. 38  
60002100666  
Kenneth I. Dunning

HOLIDAY ACRES 7  
SUBDIVISION BLOCK "A"  
P.B. 84 PG. 38  
60002100665  
Jean Sakelios

HOLIDAY ACRES 7  
SUBDIVISION BLOCK "A"  
P.B. 84 PG. 38  
60002100664  
Kenwood Valley Holdings,  
LLC

12.4430 AC

600-0210-0468  
JENNIFER WOODS, LLC  
12.443 AC PER CONVEYANCE PLAT  
RECORDED IN  
(P.B. 433 PG. 49)

ZONE "PUD"

ZONE "EE"

60000800313  
Schlear Realty Company

60000800313  
Schlear Realty Company

ZONE "E"

CURVE TABLE					
CURVE	LENGTH	RADIUS	BEARING	CHORD	DELTA
C1	19.63	12.50	S47°36'00"W	17.68	90°00'00"



0 30 60 120



CHAMPLIN  
ARCHITECTURE

424 East Fourth Street  
Cincinnati, OH 45202  
T 513.241.4474 F 513.241.0081  
thinkchamplin.com

THINK CREATE REALIZE



100 East Eighth Street  
Cincinnati, OH 45202-2133  
Tel: 513.241.3222 Fax: 513.241.2981

Heapy Engineering

Mechanical Electrical Commissioning Technology  
Autosync Recognized Leader in Sustainability / LEED

1400 West Dorothy Lane  
Dayton, OH 45409-1310  
Tel: 937.224.0861 Fax: 937.224.5777



KLEINGERS  
& ASSOCIATES  
6305 Centre Park Drive  
West Chester, OH 45069  
Tel: 513.779.7851 Fax: 513.779.7852



THE JEWISH HOSPITAL  
4777 E. GALBRAITH ROAD  
CINCINNATI, OH 45236

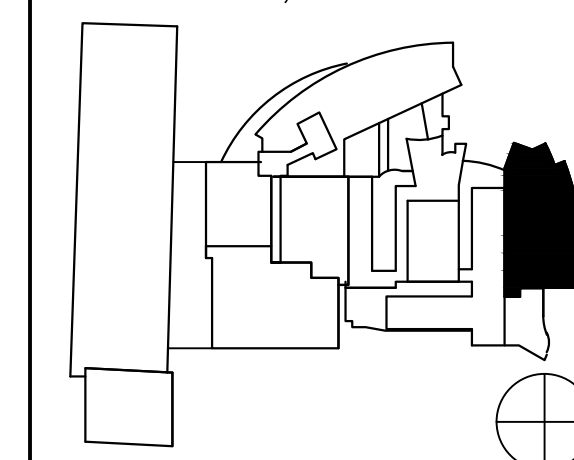

ISSUANCES

No.	Description	Date

DRAWN BY

MLZ

PRELIMINARY  
DRAWING  
ONLY

CHECKED BY

DVW

CLIENT NO.

NOT TO BE  
USED FOR  
CONSTRUCTION

PROJECT NO

4743

David V. Wright III  
E-68774  
04/18/2016

ZONING PLAT

C2

Date:

04.18.2016

H:\54\412016-4\484848.dwg, 4/18/2016 2:48:43 PM, MLZ