

N85°15'W
N85°15'W 25' 25' 4209 KUGLER MILL ROAD'

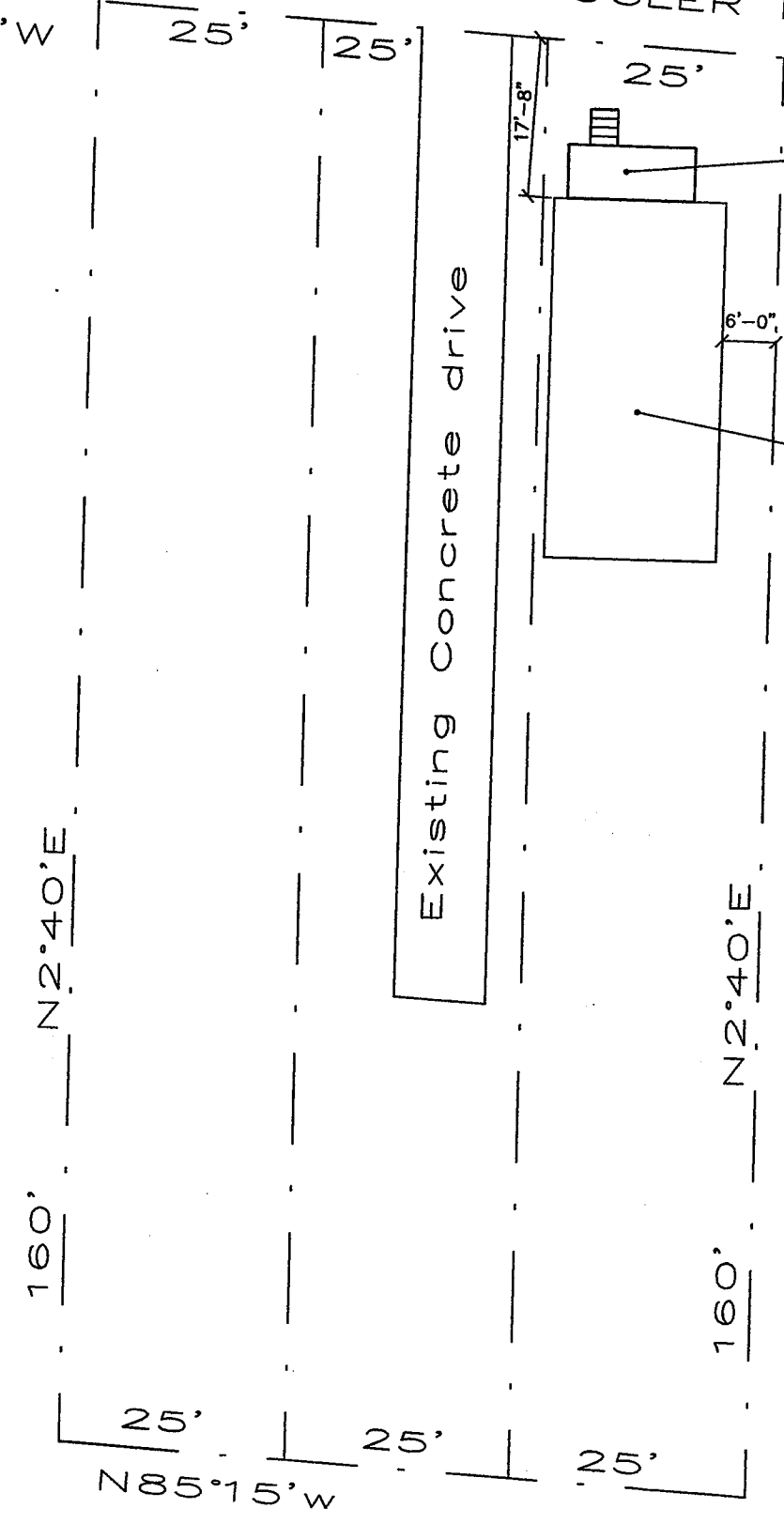

PARCEL ID 600-0203-0202-00
LUSBY SHERRY C
4209 KUGLER MILL RD
75 X 160 IRR
LOTS 364 THRU 366 BEECHWOOD
SUB PRS 202-204 CONS

Site Plan Notes:

1. Ground is level where deck is to be built.
2. No changes to existing grade.
3. New gutters on porch to be tied into existing gutters and downspouts.

SITE PLAN

SCALE: 1" = 20'-0"

WYOMING COUNTY
PLANNING & ZONING
SEP 30 2013
RECEIVED

WYOMING COUNTY
PLANNING & ZONING
SEP 24 2013
RECEIVED

HY Tech Builders

Dave Peters (513) 884-4270
Bernard ave. Reading Ohio, 45215

PROPOSED PORCH

Sherry C Lusby
4209 Kugler Mill rd Cincinnati, Ohio 45236

DATE: 9/23/13

1

SHEET # 1 of 3