

**REGULAR / A-FRAME - VERTICAL / HORIZ.
12' THRU 30' CARPORTS
(STATE OF OHIO)
AS PER DESIGN CRITERIA**

DESIGN NOTES

1. ALL CONSTRUCTION SHALL BE PROVIDED IN ACCORDANCE WITH IBC 2006, OSHA, AISC, ASCE7-05, AWS D 1.1 CODES AND ALL APPLICABLE LOCAL REQUIREMENTS.
2. SHELTER BASE CONNECTIONS SHALL BE PROVIDED AS SHOWN ON SHEET 9
3. ALL MATERIALS IDENTIFIED BY MANUFACTURER NAME MAY BE SUBSTITUTED WITH MATERIAL EQUAL OR EXCEEDING ORIGINAL.
4. ALL SHOP CONNECTIONS SHALL BE WELDED CONNECTIONS.
5. ALL FIELD CONNECTIONS SHALL BE TEKS #12 (1/4"x1/2").
6. STEEL SHEATHING SHALL BE 29GA. CORRUGATED GALV. OR PAINTED STEEL - MAIN RIB HT. 3/4" (FY=80KSI) OR EQ.
7. ALL STRUCTURAL LIGHT GAUGE TUBING AND CHANNELS SHALL BE GRADE 50 STEEL.
8. STRUCTURAL TUBE T52 1/2"x2 1/2" - 14GA. IS EQUIVALANT TO T52 1/4"x2 1/4" - 12GA.
9. STRUCTURAL TUBE T52 1/4"x2 1/4" - 12GA. SHOULD BE ACCEPTED IN LIEU OF T52 1/4"x2 1/4" - 14GA. FOR IT IS A BETTER STRUCTURAL TUBING.

DESIGN CRITERIA

PREVAILING CODE: OBC 2007
 USE GROUP: U (CARPORTS, BARN)
 BASIC WIND VELOCITY: 90 TO 100 MPH
 (SEE SCHEDULE)
 ROOF DEAD LOAD: 2.0 PSF
 ROOF LIVE LOAD: AS PER GROUND SNOW
 20 PSF
 GROUND SNOW LOAD: 20 TO 30 PSF
 (SEE SCHEDULE)
 IMPORTANCE FACTOR = SNOW 0.8
 WIND 0.87
 SEISMIC 1.0
 SEISMIC DESIGN CATEGORY: A
 LOAD COMBINATIONS:
 DL+LL, 0.6DL+WL
 DL+0.75LL+0.75WL

DRAWING INDEX

- 1.....COVER SHEET
- 2.....FLOOR PLAN
- 3.....REGULAR / AFRAME BLDG. SECTIONS
- 4.....SIDE ELEVATIONS
- 5.....SECTION DETAILS
- 6.....END WALL DETAILS
- 7.....OPENING DETAILS
- 8.....LEAN-TO OPTION
- 9.....ANCHORAGE

THE INFORMATION CONTAINED IN THESE DRAWINGS ARE THE SOLE PROPERTY OF A & A ENGINEERING. ANY REPRODUCTION IN PART OR WHOLE WITHOUT THE WRITTEN PERMISSION OF A & A ENGINEERING IS PROHIBITED.



5911 Renaissance Pl., Suite B Toledo, Ohio 43623 Tel: (419) 292-1983 Fax: (419) 292-0955

FOR:
ALL STEEL CARPORTS INC.
 LOCATION ADDRESS: 908 S. MOUND ST. #3 MUNCIE, IN 47302
 MAILING ADDRESS: P.O. BOX 187 YORKTOWN, IN 47396
 MAIN - (765) 284-0694
 TOLL FREE (800) 710-7906 FAX - (765) 284-2689

OWNER: **ALL STEEL CARPORTS**
 LOCATION: **OHIO**
 DRAWING NO.: **ASC-12**
 DATE: **11/23/2010**
 PROJECT NUMBER: **034-10-0981**
 DRAWN BY: **JMS**
 CHECKED BY: **OA**
 DRAWING TITLE: **COVER**

SHEET NO.: **1 OF 9**

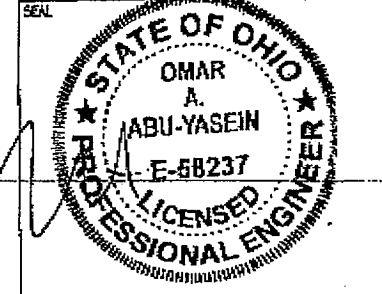

LICENSE EXPIRES: **12/31/2011**
 DATE SIGNED: **1/19/2011**

WINDOW/DOOR SIZES AND LOCATIONS
PER CUSTOMER REQUEST

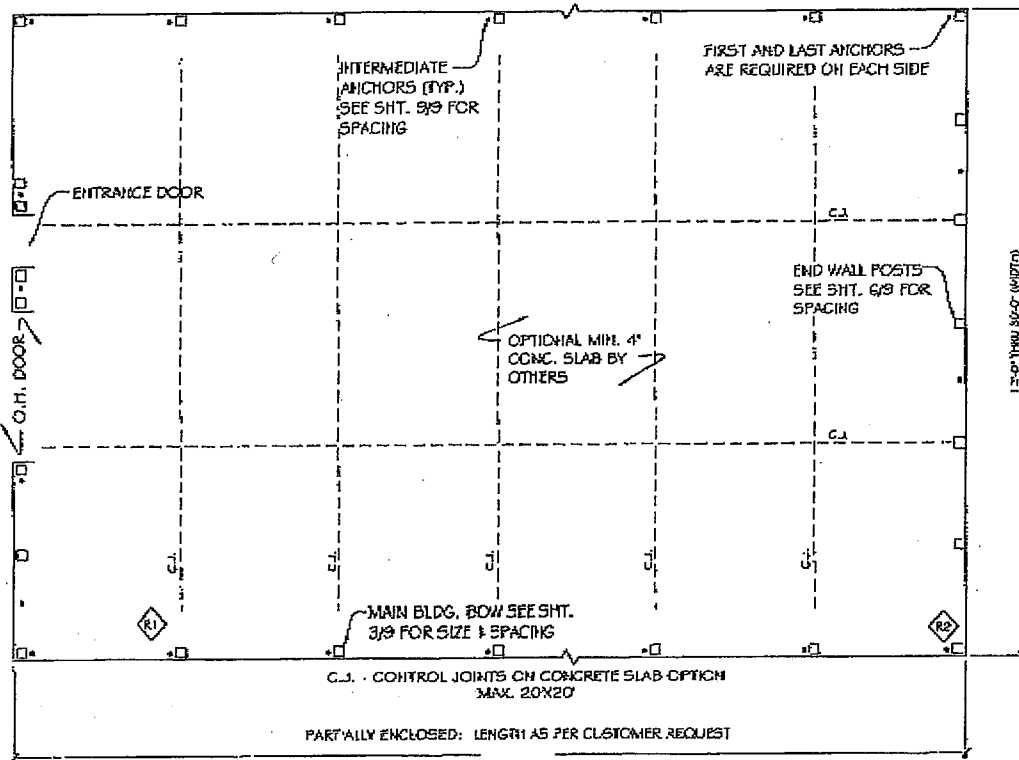

PARTIALLY ENCLOSED: LENGTH AS PER CUSTOMER REQUEST
FULLY ENCLOSED: 12' THRU 20', MAX. LENGTH = 50'-0"
22' THRU 30', MAX. LENGTH = 100'-0"

FLOOR PLAN
(SCALE: NTS)

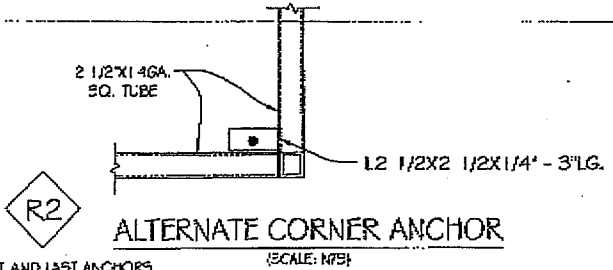
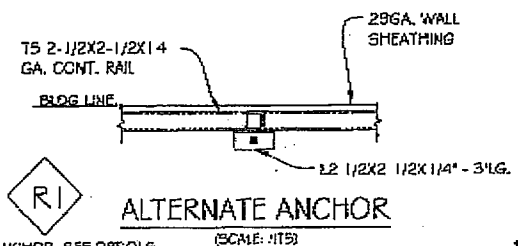
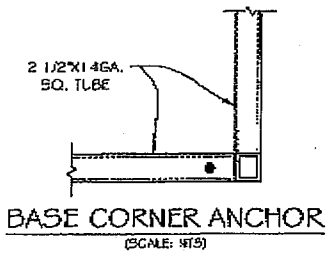
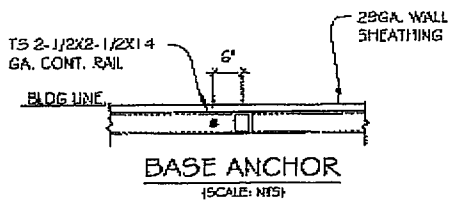

ANCHOR, SEE OPT/OALS AND SPACING SHEET 3/9

FIRST AND LAST ANCHORS ARE REQUIRED IN EACH SIDE



5911 Renaissance Pl., Suite B Toledo, Ohio 43623
Tel: (419) 292-1983 Fax: (419) 292-0955

FOR:
ALL STEEL CARPORTS INC.
LOCATION ADDRESS: 908 S. MOUND ST. #3 MUNCIE, IN 47302
MAILING ADDRESS: P.O. BOX 187 YORKTOWN, IN 47396
MAIN - (765) 284-0694
TOLL FREE (800) 710-7906 FAX - (765) 284-2689

OWNER: **ALL STEEL CARPORTS**
LOCATION: **OHIO**
DRAWING NO.: **ASC-12**
DATE: **11/23/2010**
PROJECT NUMBER: **034-10-0981**
DRAWN BY: **JMS**
CHECKED BY: **OA**
DRAWING TITLE: **FLOOR PLAN**
SHEET NO.: **2 OF 9**

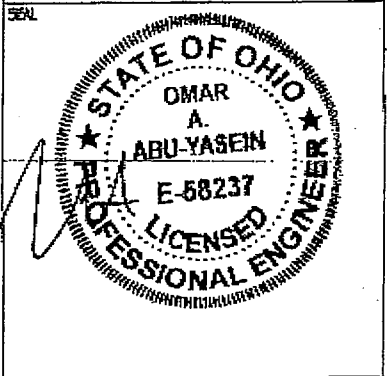

DATE SIGNED: **1/19/2011**

10/31/2011 09:17 7652842689 ALL STE PAGE 03/13



5911 Renaissance Pl., Suite B Toledo, Ohio 43623 Tel: (419) 292-1983 Fax: (419) 292-0955

FOR: **ALL STEEL CARPORTS INC.**
 LOCATION ADDRESS: 908 S. MOUND ST. #3 MUNCIE, IN 47302
 MAILING ADDRESS: P.O. BOX 187 YORKTOWN, IN 47396
 MAIN: (765) 284-0694 TOLL FREE: (800) 790-7906 FAX: (765) 284-2689

OWNER: **ALL STEEL CARPORTS**
 LOCATION: OHIO
 DRAWING NO.: ASC-12
 DATE: 11/23/2010
 PROJECT NUMBER: 034-10-0981
 DRAWN BY: JMS
 CHECKED BY: OA
 DRAWING TITLE: **TYP BLDG. SECTION**
 SHEET NO.: 3 OF 8

SEAL: **STATE OF OHIO**
 OMAR A. ABU-YASEIN
 E-58237
 PROFESSIONAL ENGINEER
 DATE SIGNED: 1/19/2011

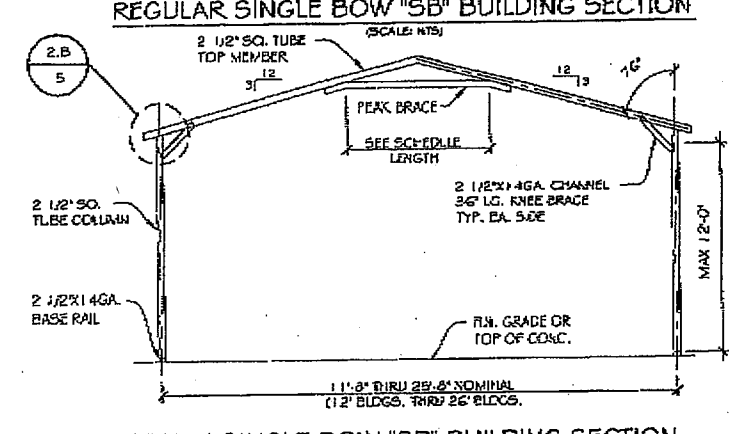
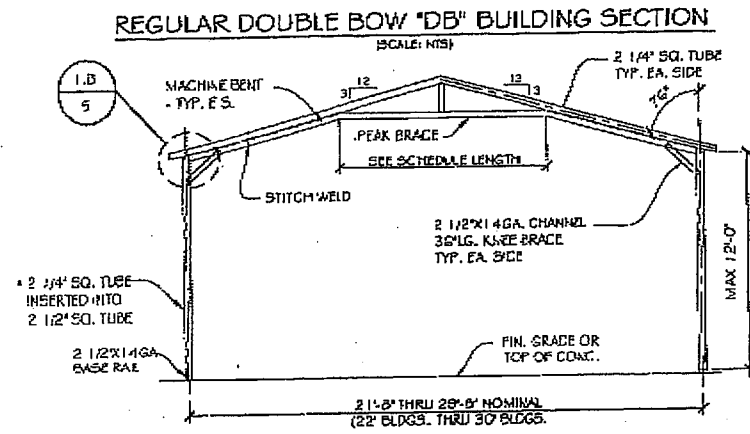
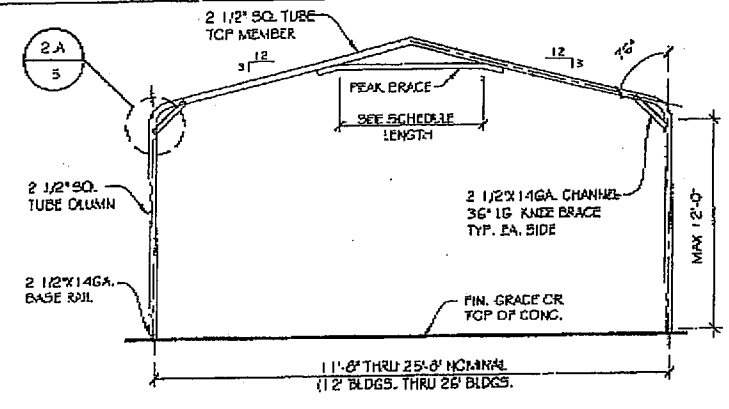
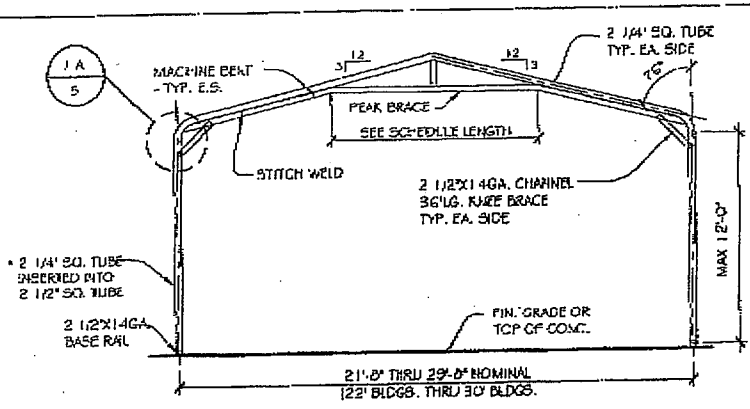

A-FRAME DOUBLE BOW "DB" BUILDING SECTION (SCALE: NTS)

A-FRAME SINGLE BOW "SB" BUILDING SECTION (SCALE: NTS)

* INSERT TO BE FULL HEIGHT. FIELD BOLT W/ TEKS #12X1" @ 12" O.C. - STAGGER OPPOSITE FACE

BOW SCHEDULE (TOP & COLUMN MEMBERS GAUGE AND SPACING)

WIND (MPH)		90 - 100			
GS / LL	POST HT.	BLDG. & WIDTH			
		12-20	22-26	28-30	
20 / 20	5'-0" TO 8'-0"	F	14GA. S.B. @ 60"	14GA. S.B. @ 60"	14GA. D.B. @ 60"
		P	14GA. S.B. @ 60"	14GA. S.B. @ 54"	14GA. D.B. @ 60"
	9'-0" TO 12'-0"	F	14GA. S.B. @ 60"	14GA. S.B. @ 60"	14GA. D.B. @ 54"
		P	14GA. S.B. @ 60"	14GA. S.B. @ 54"	14GA. D.B. @ 54"
30 / 20	5'-0" TO 8'-0"	F	14GA. S.B. @ 60"	14GA. S.B. @ 54"	14GA. D.B. @ 60"
		P	14GA. S.B. @ 60"	14GA. S.B. @ 48"	14GA. D.B. @ 60"
	9'-0" TO 12'-0"	F	14GA. S.B. @ 60"	14GA. S.B. @ 54"	14GA. D.B. @ 54"
		P	14GA. S.B. @ 54"	14GA. S.B. @ 48"	14GA. D.B. @ 54"

S.B. = SINGLE BOW
 D.B. = DOUBLE BOW
 F = FULLY ENCLOSED (CLOSED)
 P = PARTIALLY ENCLOSED (OPEN)
 G.S. = GROUND SNOW
 L.L. = LIVE LOAD

PEAK BRACE SCHEDULE

WIDTH	SIZE	LENGTH
12	2 1/2" X 14GA. CHANNEL	2'-0"
14	2 1/2" X 14GA. CHANNEL	2'-0"
16	2 1/2" X 14GA. CHANNEL	2'-0"
18	2 1/2" X 14GA. CHANNEL	2'-0"
20-22	2 1/4" X 14GA. SQ. TUBE	1'-0"
24-26	2 1/4" X 14GA. SQ. TUBE	1'-0"
28-30	2 1/4" X 14GA. SQ. TUBE	1'-0"

10/31/2011 09:17 7652842689 ALL SITE PAGE 04/13



A & A ENGINEERING
 CIVIL • STRUCTURAL
 SINCE 1974

5911 Renaissance Pl., Suite B Toledo, Ohio 43623
 Tel: (419) 292-1983 Fax: (419) 292-0955

FOR:

ALL STEEL CARPORTS INC.

LOCATION ADDRESS: 908 S. MOUND ST. #3
 MUNCIE, IN 47302

MAILING ADDRESS: P.O. BOX 187
 YORKTOWN, IN 47396

MAIN - (765) 284-0694
 TOLL FREE (800) 730-3966 FAX - (765) 284-2689

OWNER:
ALL STEEL CARPORTS

LOCATION: OHIO

DRAWING NO.: ASC-12

DATE: 11/23/2010

PROJECT NUMBER:
 034-10-0981

DRAWN BY: JMS

CHECKED BY: OA

DRAWING TITLE:
SIDE ELEVATIONS

SHEET NO.: 4 OF 9

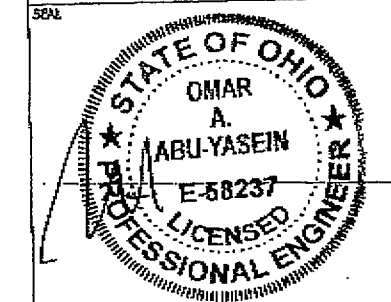

DATE SIGNED: 1/19/2011

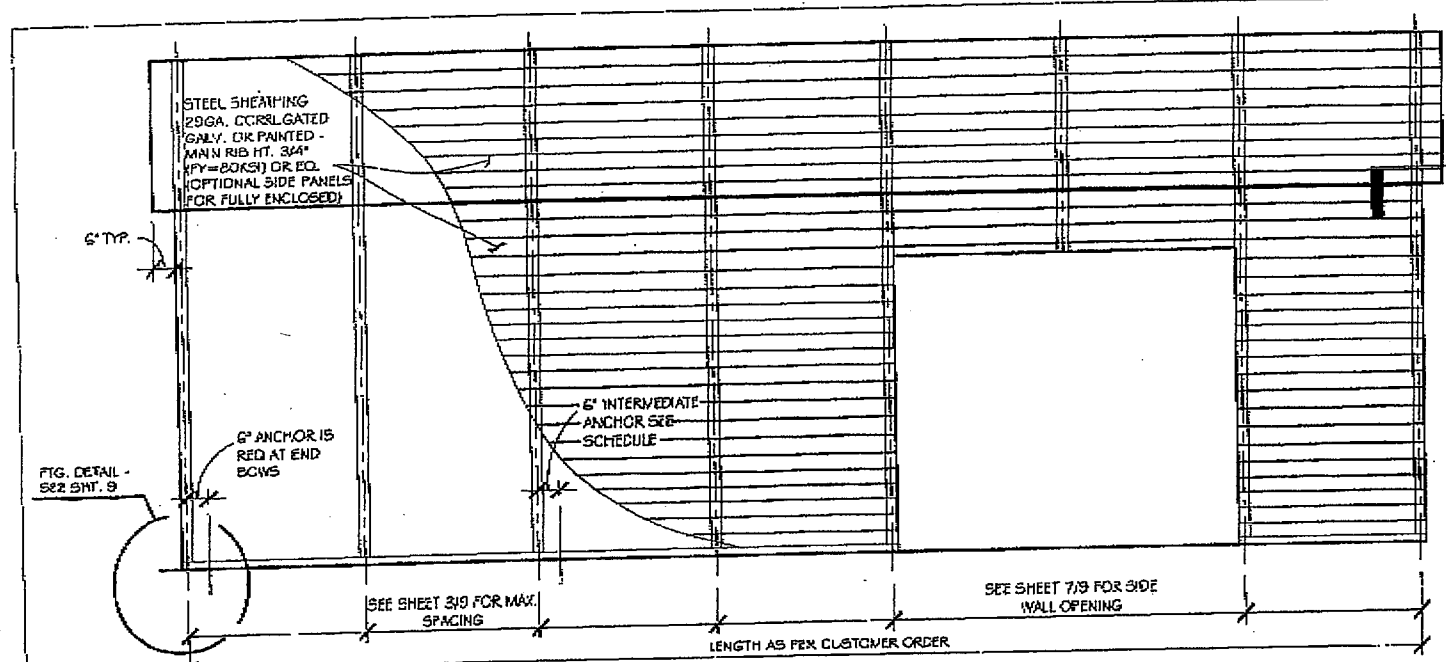

HORIZ. SIDE ELEVATION
 (SCALE: NTS)

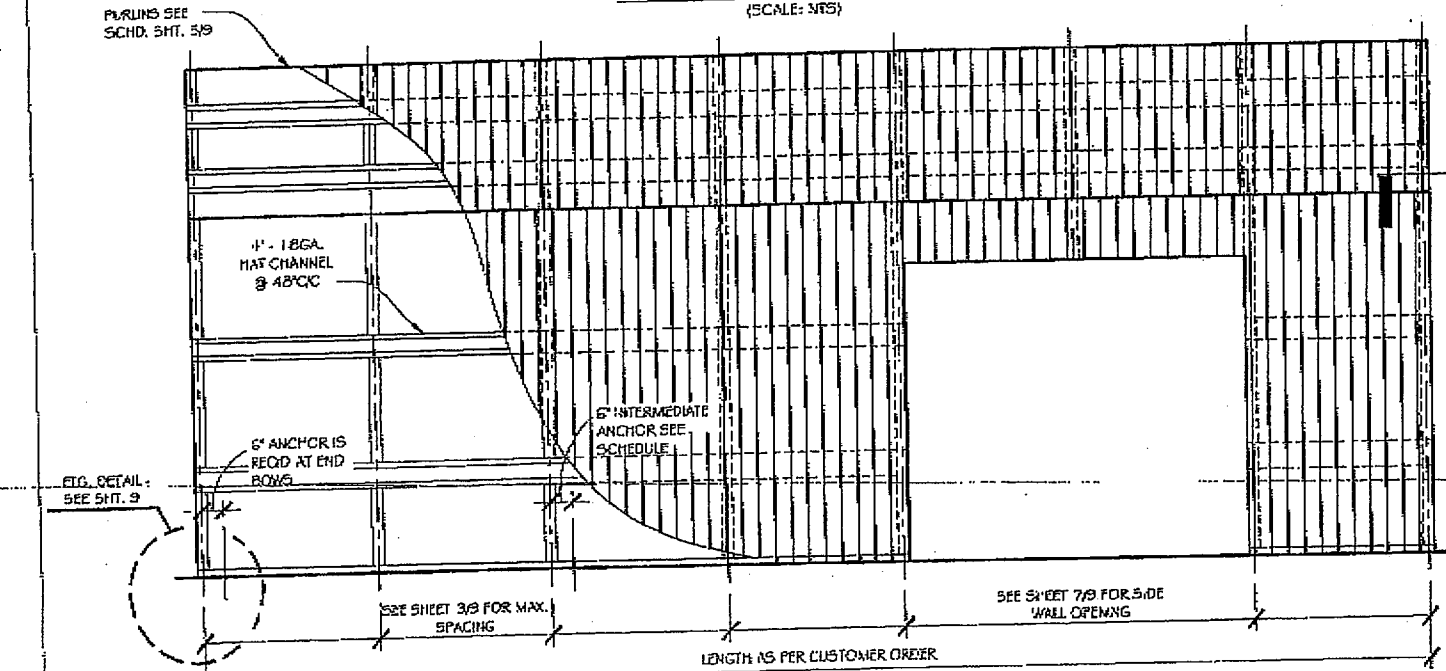

VERTICAL SIDE ELEVATION
 (SCALE: NTS)



A & A ENGINEERING
 CIVIL • STRUCTURAL
 SINCE 1994

5911 Renaissance Pl., Suite B Toledo, Ohio 43623
 Tel: (419) 292-1983 Fax: (419) 292-1955

FOR:
ALL STEEL CARPORTS INC.
 LOCATION ADDRESS: 908 S. MOUND ST. #3 MUNCIE, IN 47302
 MAILING ADDRESS: P.O. BOX 187 YORKTOWN, IN 47396
 MAIN - (765) 284-0494
 TOLL FREE (800) 730-7906 FAX - (765) 284-2689

OWNER:
ALL STEEL CARPORTS

LOCATION: OHIO

DRAWING NO.: ASC-12

DATE: 11/23/2010

PROJECT NUMBER:
 034-10-0981

DRAWN BY: JMS

CHECKED BY: OA

DRAWING TITLE:
SECTION DETAILS

SHEET NO.: 5 OF 9

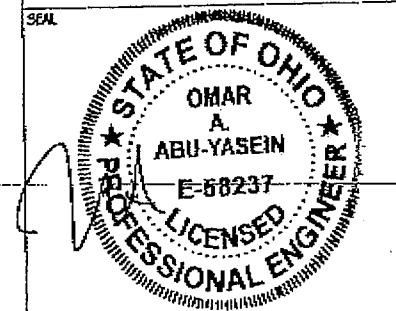

DATE SIGNED: 1/19/2011

PURLIN SCHD.	
SNOW LOAD	HAT CHANNEL SPACING
20	48" C/C
30	48" C/C

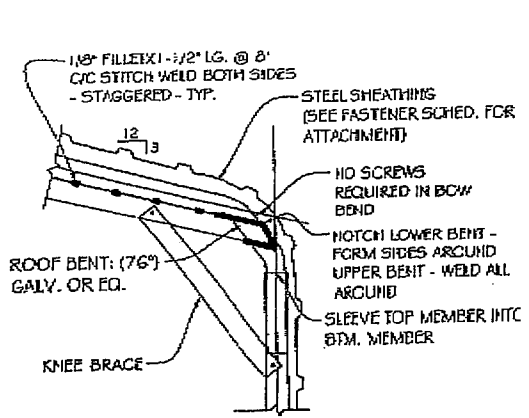

REGULAR DOUBLE BOW SECTION DETAIL (1.A)
 (SCALE: NTS)

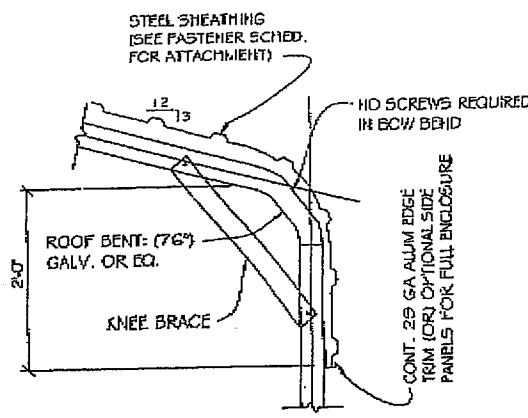

REGULAR SINGLE BOW SECTION DETAIL (2.A)
 (SCALE: NTS)

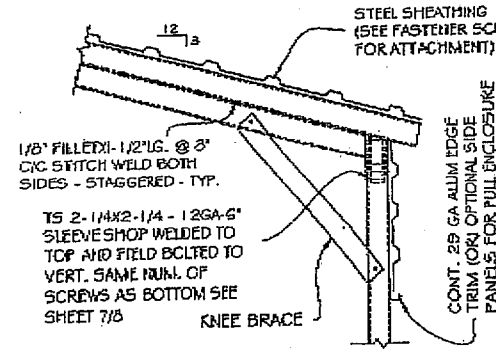

A-FRAME DOUBLE BOW SECTION DETAIL (1.B)
 (SCALE: NTS)

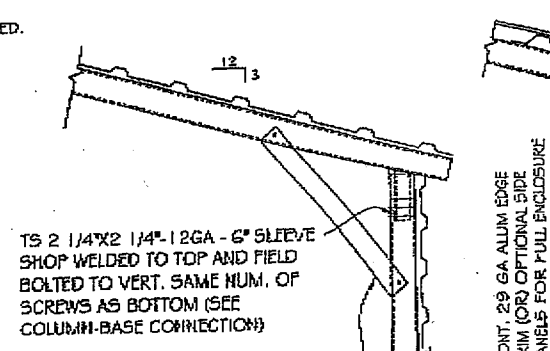

A-FRAME SINGLE BOW SECTION DETAIL (2.B)
 (SCALE: NTS)

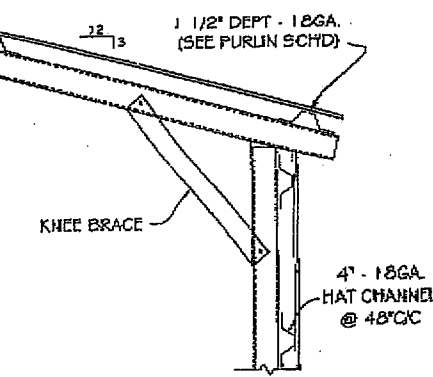

TYPICAL A-FRAME VERTICAL SECTION DETAIL
 (SCALE: NTS)

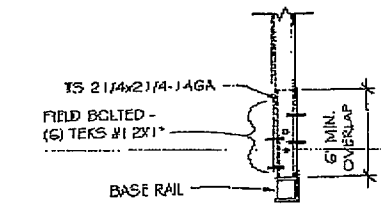

COLUMN/BASE RAIL DETAIL
 (SCALE: NTS)

FASTENER SCHED.:
 TYPE: TEKS #1 2X1" SCREWS W/ NEOPRENE/STEEL WASHER @ 6"C/C OF CORNER PANEL AND 8"C/C ELSEWHERE. MIN. ONE FAST. PER SPAN AT SIDE LAP PANELS MIN. 4" C/C AT EDGE LAP PANELS W/ SILICON CAULK IN BETWEEN PANELS.

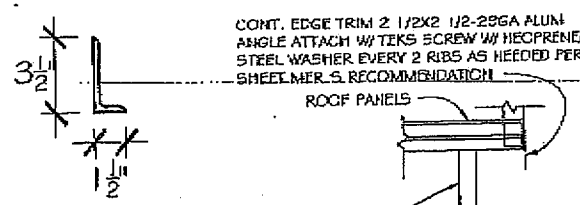

TRIM DETAIL
 (SCALE: NTS)

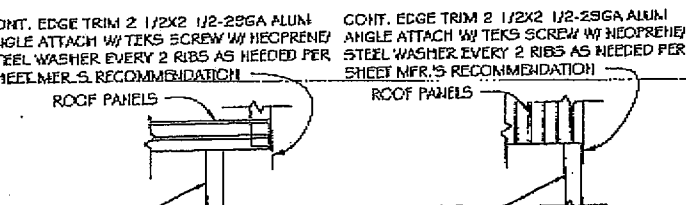

EDGE DETAIL (1)
 (SCALE: NTS)

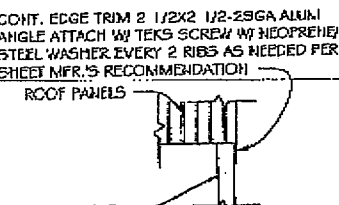

EDGE DETAIL (2)
 (SCALE: NTS)

10/31/2011 09:17 7652842689 ALL STE PAGE 06/13

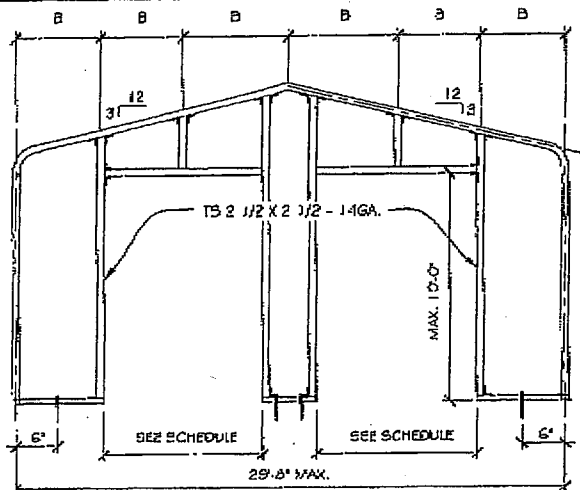

REGULAR END WALL W/ OPENING
(SCALE: NTS)

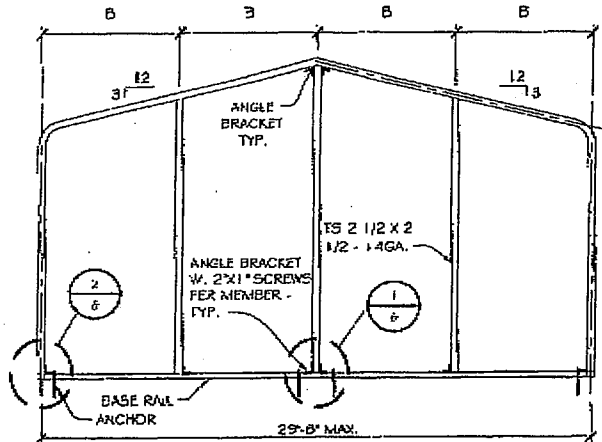

REGULAR END WALL
(SCALE: NTS)

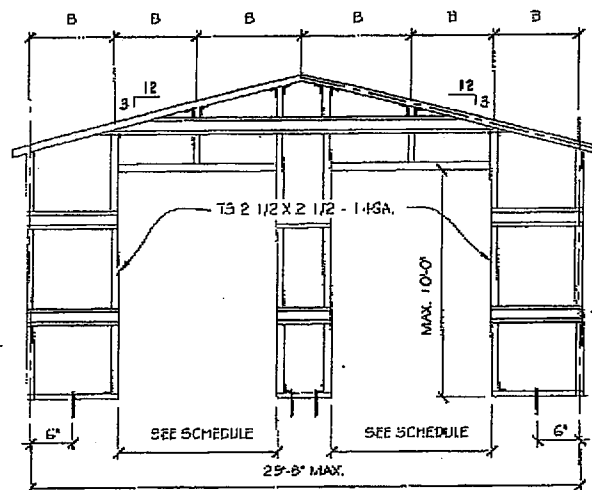

A-FRAME END WALL W/ OPENING
(SCALE: NTS)

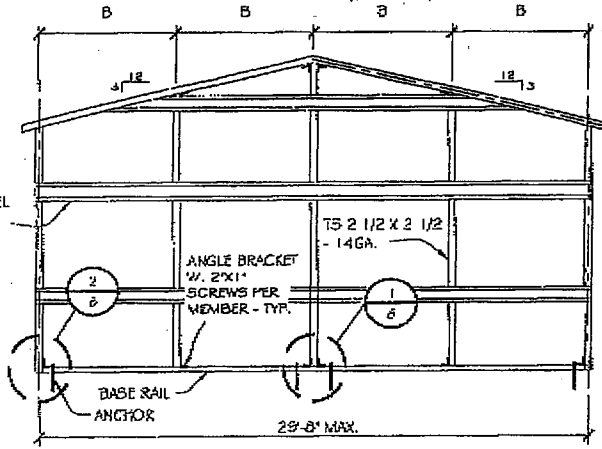

A-FRAME END WALL
(SCALE: NTS)

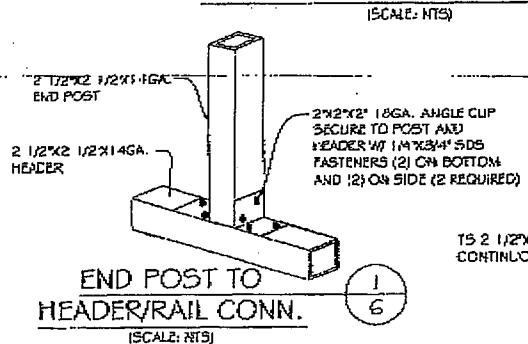

END POST TO HEADER/RAIL CONN.
(SCALE: NTS)

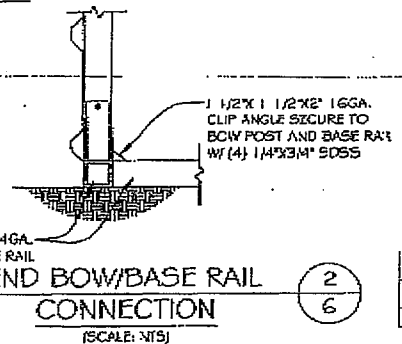

END BOW/BASE RAIL CONNECTION
(SCALE: NTS)

MAX. END WALL OPENING

CARPORT WIDTH	MAX. DOOR WIDTH	HEADER SIZE
12'-10"	8'	TS 2-1/4X 2-1/4 - 12GA.
18'	10'	TS 2 1/4X 2 1/4 - 12GA.
20'-22'	12'	TS 2 1/4X 2 1/4 - 12GA.
24'-30'	14'	DBL TS 2 1/4X 2 1/4 - 14GA.

MAX. POST SPACING "B"

END WALL SCHEDULE		
WIND	POST SPACING "B"	ANCHORS
50 - 100	5'-0" C/C	EVERY OTHER POST "B"



5911 Renaissance Pl, Suite B Toledo, Ohio 43623
Tel: (419) 292-1983 Fax: (419) 292-0955

FOR:
ALL STEEL CARPORTS INC.
LOCATION ADDRESS: 908 S. MOUND ST. #3 MUNCIE, IN 47302
MAILING ADDRESS: P.O. BOX 187 YORKTOWN, IN 47396
MAIN - (765) 234-0594
TOLL FREE (800) 730-1906 FAX - (765) 234-2689

OWNER:
ALL STEEL CARPORTS

LOCATION: OHIO

DRAWING NO.: ASC-12

DATE: 11/23/2010

PROJECT NUMBER:
034-10-0981

DRAWN BY: JMS

CHECKED BY: OA

DRAWING TITLE:
END WALL DETAILS

SHEET NO.: 6 OF 9

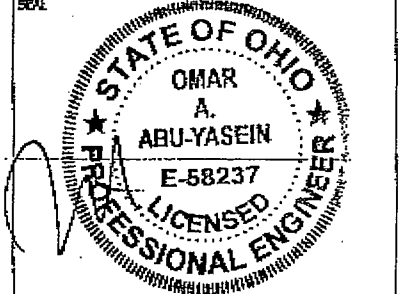

DATE SIGNED: 1/19/2011

1/19/2011 09:17 7652842689 ALL SITE PAGE 07/13

FOR:

ALL STEEL CARPORTS INC.

LOCATION ADDRESS: 908 S. MOUND ST. #3
 MUNCIE, IN 47302
 MAILING ADDRESS: P.O. BOX 187
 YORKTOWN, IN 47396

MADE: (765) 284-0694
 TOLL FREE (800) 730-0906 FAX: (765) 284-2689

OWNER:
ALL STEEL CARPORTS

LOCATION: **OHIO**

DRAWING NO.: **ASC-12**

DATE: **11/23/2010**

PROJECT NUMBER:
034-10-0981

DRAWN BY: **JMS**

CHECKED BY: **OA**

DRAWING TITLE:
**SIDE WALL
 OPENNING DETAILS**

SHEET NO.: **7 OF 9**

SEAL

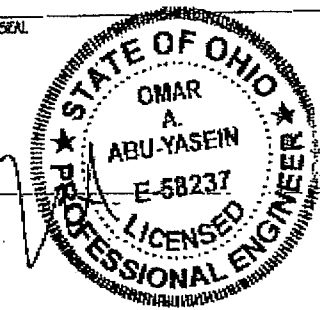

DATE SIGNED: **1/19/2011**

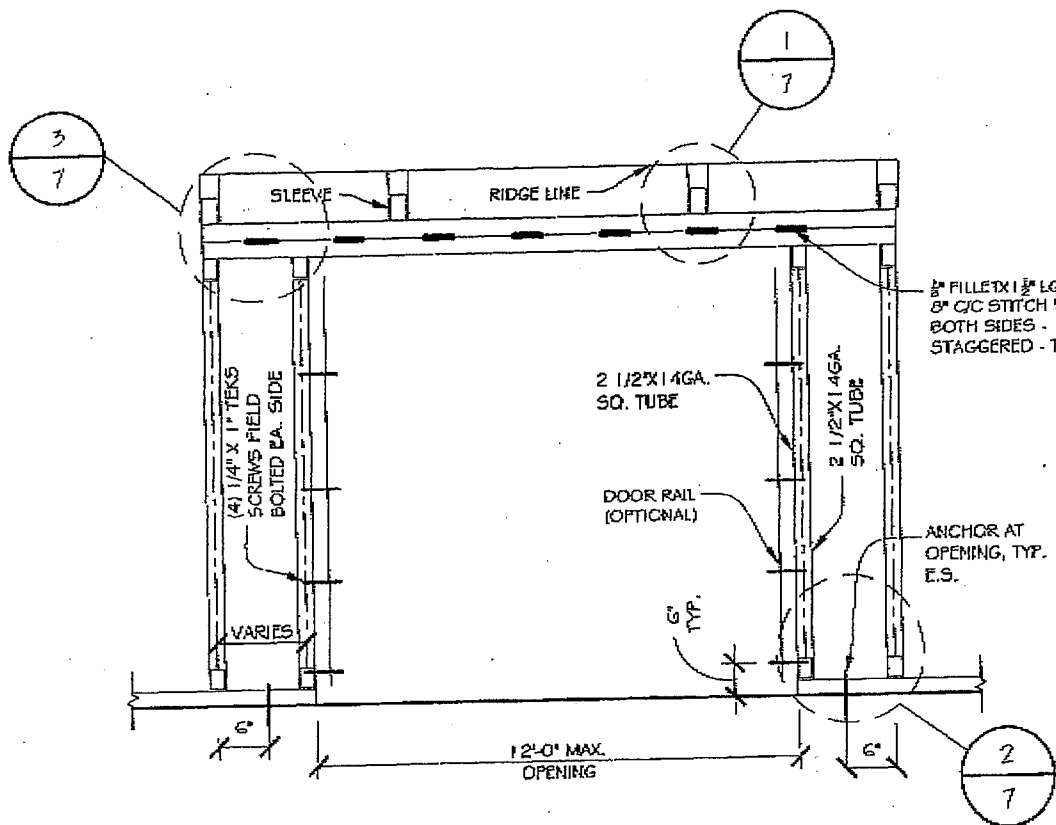

TYPICAL FRAMING AT SIDE OPENINGS
 (SCALE: NTS)

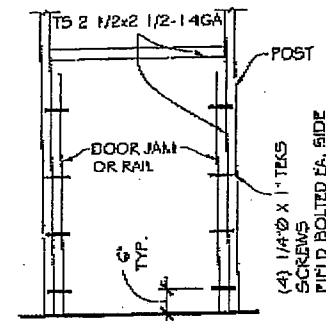

TYPICAL DOOR FRAMING
 (SCALE: NTS)

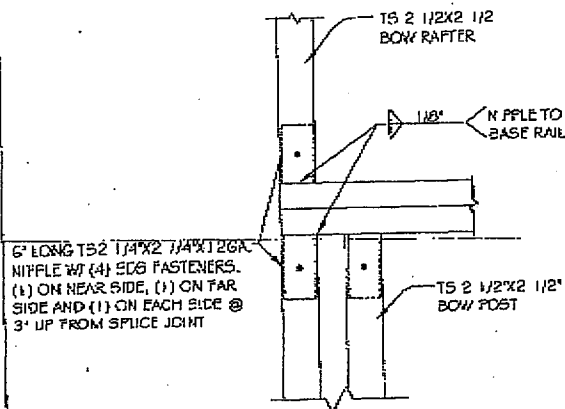

BOW/POST DETAIL
 (SCALE: NTS)

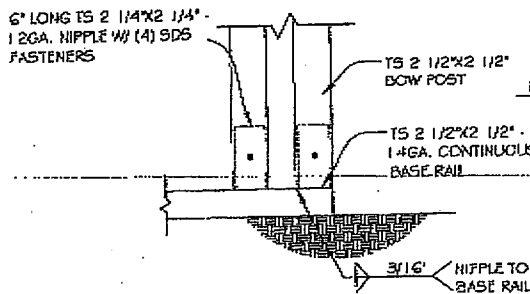

BOW/BASE RAIL CONN. DETAIL
 (SCALE: NTS)

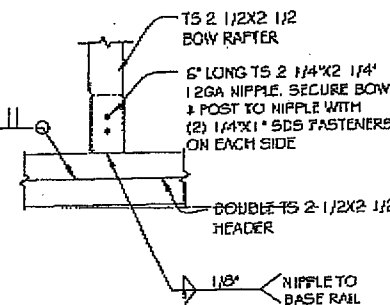

BOW/HEADER DETAIL
 (SCALE: NTS)



A & A ENGINEERING
 CIVIL - STRUCTURAL
 SINCE 1994

5911 Renaissance Pl., Suite B Toledo, Ohio 43623
 Tel: (419) 292-1983 Fax: (419) 292-0955

FOR:

ALL STEEL CARPORTS INC.

LOCATION ADDRESS: 908 S. MOUND ST. #3
 MUNCIE, IN 47302

MAILING ADDRESS:
 P.O. BOX 187
 YORKTOWN, IN 47396

MAIN - (765) 284-0694
 TOLL FREE (800) 730-7905 FAX - (765) 284-2669

OWNER:

ALL STEEL CARPORTS

LOCATION: OHIO

DRAWING NO.: ASC-12

DATE: 11/23/2010

PROJECT NUMBER:
 034-10-0981

DRAWN BY: JMS

CHECKED BY: OA

DRAWING TITLE:

LEAN-TO OPTION

SHEET NO.: 8 OF 9

SEALED

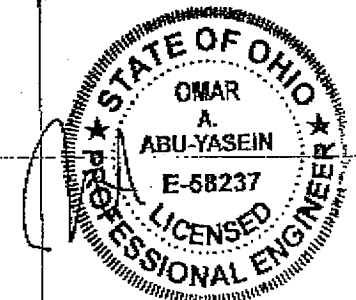

DATE SIGNED:

1/19/2011

10/31/2011

09:17

7652842689

ALL SITE

PAGE 09/13

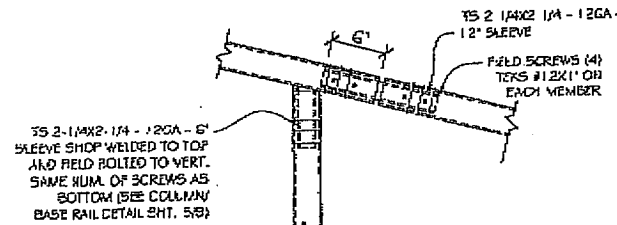

CONNECTION DETAIL 1

(SCALE: 1/4"=1')

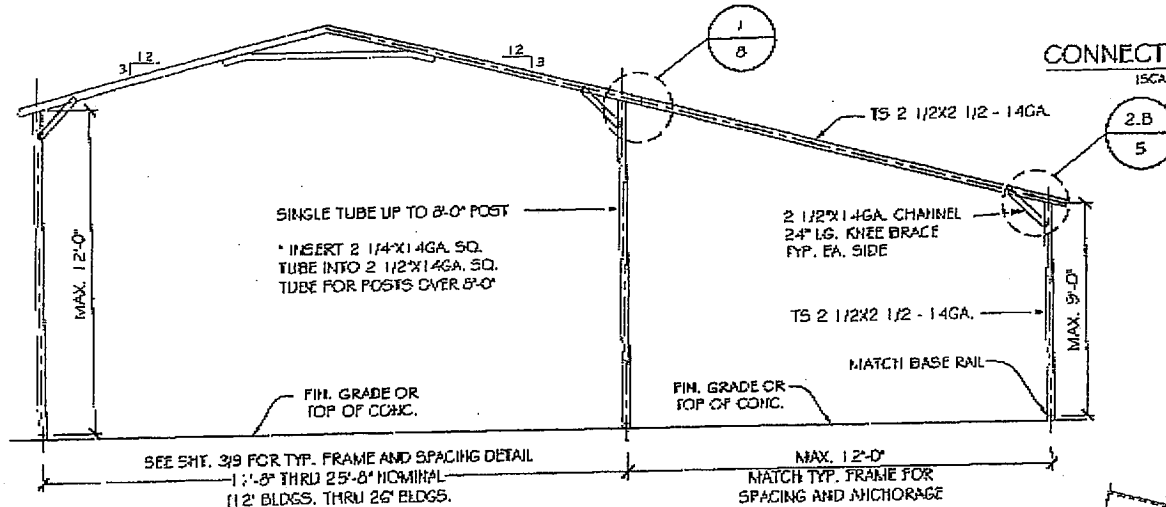

A-FRAME OR REGULAR "SB" LEAN-TO OPTION

(SCALE: 1/4"=1')

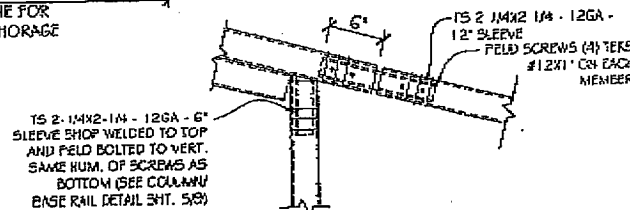

CONNECTION DETAIL 2

(SCALE: 1/4"=1')

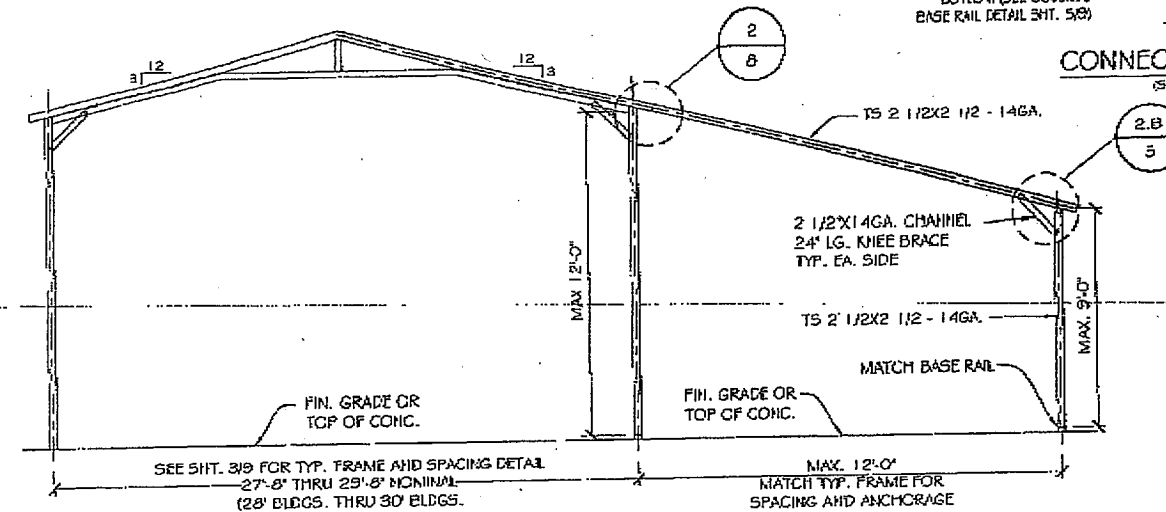

A-FRAME OR REGULAR "DB" LEAN-TO OPTION

(SCALE: 1/4"=1')

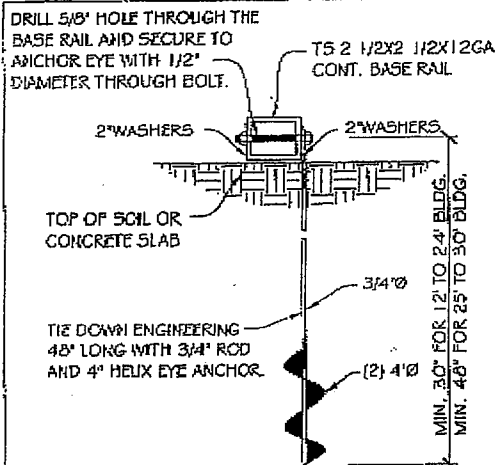

OPTIONAL MOBILE HOME ANCHOR FOR SAND/CLAY
(SCALE: NTS)

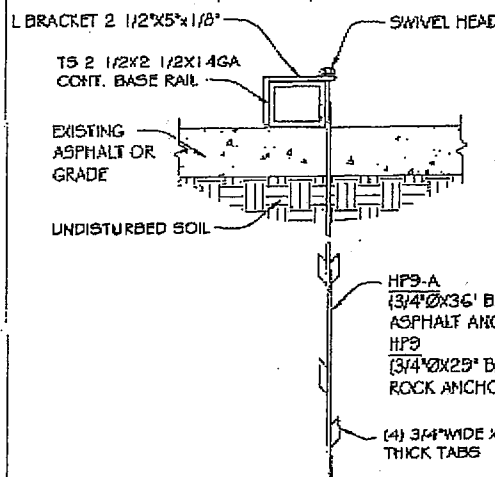

OPTIONAL ASPHALT/ ROCK ANCHOR DETAIL
(SCALE: NTS)

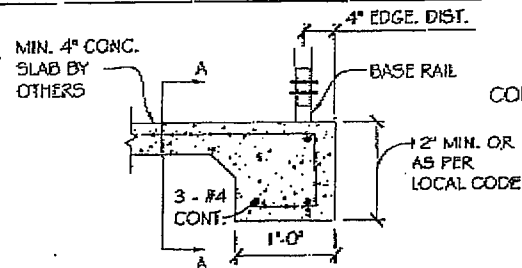

BASE OPTIONAL ANCHOR ON CONC. SLAB SECTION
(SCALE: NTS)

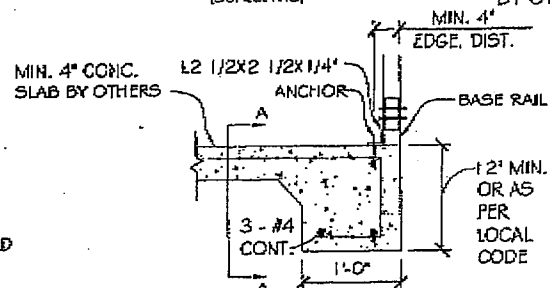

ALTERNATE, FRAME FLUSH W/ CONC.
(SCALE: NTS)

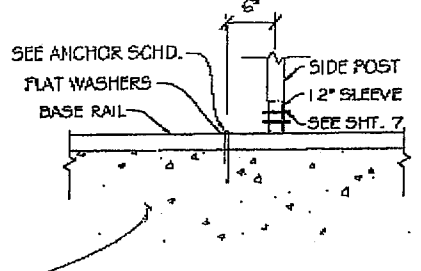

SECTION A-A
(SCALE: NTS)

- NOTE:
 1: SEE SHE. 2 AND 6 FOR ANCHOR REQUIREMENTS
 2: ASSUMED SOIL BEARING CAPACITY IS 1500 PSF
 3: CONCRETE STRENGTH TO BE 2500 PSI AT 28 DAYS

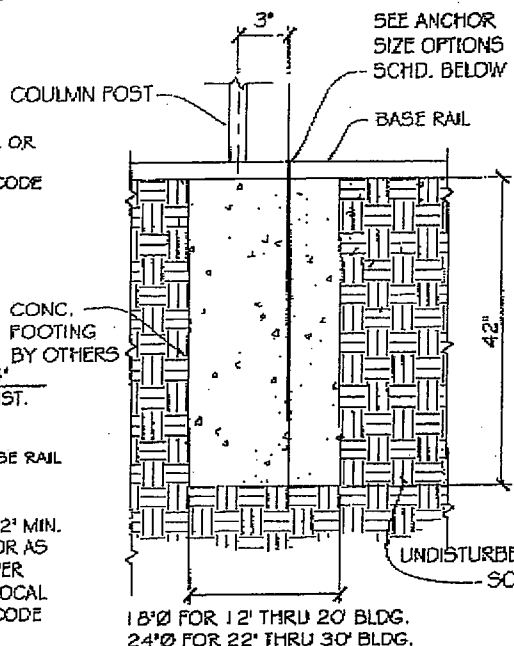

PIN ANCHOR DETAIL ON CONCRETE PIER FOOTING
(SCALE: NTS)

NOTE:
 ON LEVEL GRADE DIG A 1 8/16\"/>

SOIL CLASSIFICATIONS:

SOIL CLASS	SOIL DESCRIPTION
2	VERY DENSE #7 OR CEMENTED SANDS, COURSE GRAVEL AND COBBLES, COLLECTIVE, PRELOADED SILT AND CLAYS
3	MEDIUM DENSE COARSE SANDS, SANDY GRAVELS, VERY STIFF SILTS, AND CLAYS
4	LOOSE TO MEDIUM DENSE SANDS, FIRM TO STIFF CLAYS AND SILTS ALLUVIAL FILL AND VERY LOOSE TO MEDIUM DENSE SANDS, FIRM TO STIFF CLAYS AND SILTS, ALLUVIAL FILL

HELICAL ANCHOR SHALL BE APPROVED FOR USE IN SOIL CLASSIFICATIONS 2, 3, AND 4.

TAKEN FROM HUD STANDARD FOR INSTALLATION OF MOBILE HOMES



5011 Renaissance Pl. Suite B Tel: (419) 292-1983
 Toledo, Ohio 43623 Fax: (419) 292-0255

FOR:

ALL STEEL CARPORTS INC.

LOCATION ADDRESS: 908 S. MOUND ST. #3
 MUNCIE, IN 47302

MAILING ADDRESS: P.O. BOX 187
 YORKTOWN, IN 47396

MAIN - (765) 284-0694
 TOLL FREE (800) 710-7306 FAX - (765) 284-2649

OWNER:

ALL STEEL CARPORTS

LOCATION: OHIO

DRAWING NO.: ASC-12

DATE: 11/23/2010

PROJECT NUMBER:
 034-10-0981

DRAWN BY: JMS

CHECKED BY: OA

DRAWING TITLE:
ANCHOR OPTIONS

SHEET NO.: 9 OF 9

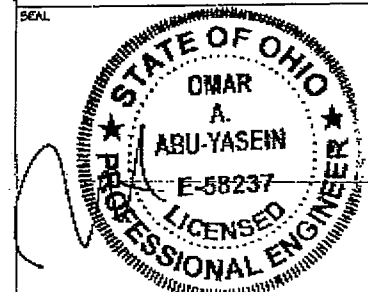

DATE SIGNED: 11/19/2011

ANCHOR SIZE OPTIONS SCHEDULE

	WIND SPEED (MPH)	REMARKS	CARPORT WIDTH
	90 - 100		
1	5/8"ØX20"	THRD. ROD EMBED IN CONC.	ALL SIZES
2	5/8"ØX7"	INSERT W/ EPOXY IN CONC.	ALL SIZES
3	3/8"ØX7"	EXPANSION BOLTS	ALL SIZES
4	5/8"ØX7"	WEDGE ANCHORS IN CONC.	ALL SIZES

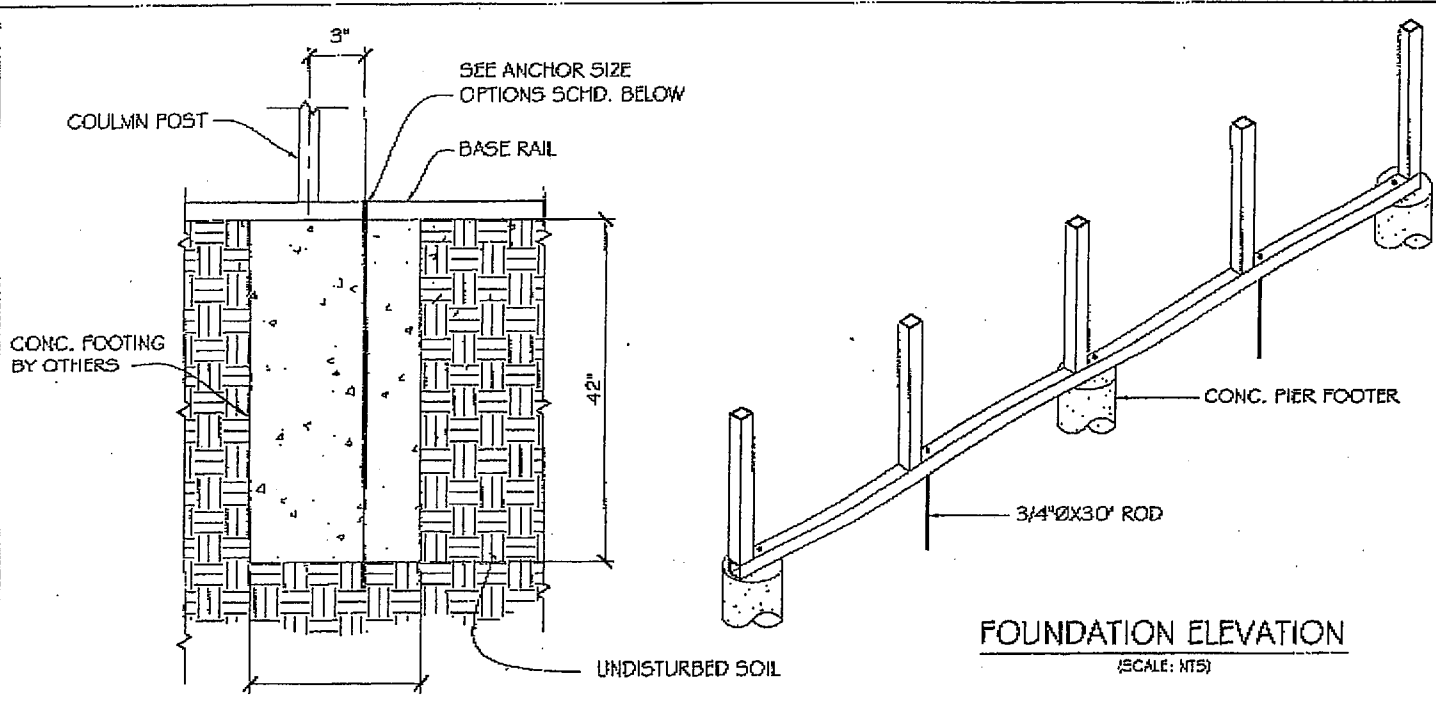

1.8"Ø FOR 12' THRU 20' BLDG.
2.4"Ø FOR 22' THRU 30' BLDG.

**PIN ANCHOR DETAIL ON
CONCRETE PIER FOOTING**

(SCALE: NTS)

NOTE:
ON LEVEL GRADE DIG A 1.8"/2.4" HOLE 42" DEEP AT EACH ANCHOR POINT. REPOSITION BASE RAILS OVER HOLES AND DROP A GROUND ANCHOR THROUGH EACH HOLE IN BASE RAILS. FILL EACH HOLE WITH 2500 PSI CONCRETE

NOTES:

1. CONCRETE PIERS SHALL BE REQUIRED AT ALL CORNER POSTS AND AT EVERY OTHER POST BUT SHALL NOT EXCEED 10'-0" C/C SPACING IN ANY DIRECTION
2. ALL OTHER POSTS WITH NO CONCRETE PIER ANCHOR SHALL BE ANCHORED TO THE GROUND WITH 3/4"X30" LG. ROD. RODS SHALL HAVE A WELDED NUT AT TOP AND ONE COAT OF RLST PROVE PRIMER PAINT.
3. ASSUMED SOIL BEARING CAPACITY IS TO BE A MIN. 1500 PSF
4. CONCRETE STRENGTH TO BE A MIN. OF 2500 PSI AT 28 DAYS

ANCHOR SIZE OPTIONS SCHEDULE

	WIND SPEED (MPH)	REMARKS	CARPORT WIDTH
	90 - 100		
1	5/8"ØX20"	THRD. ROD EMBED IN CONC	ALL SIZES
2	5/8"ØX7"	INSERT W/ EPOXY IN CONC.	ALL SIZES
3	5/8"ØX7"	EXPANSION BOLTS	ALL SIZES
4	5/8"ØX7"	WEDGE ANCHORS IN CONC.	ALL SIZES

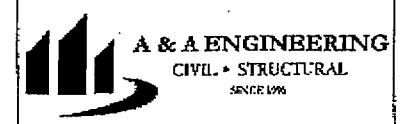

5911 Renaissance Pl., Suite B
Toledo, Ohio 43623
Tel: (419) 292-1983
Fax: (419) 292-0955

FOR:
ALL STEEL CARPORTS INC.
LOCATION ADDRESS: 908 S. MOUND ST. #3
MUNCIE, IN 47302
MAILING ADDRESS: P.O. BOX 187
YORKTOWN, IN 47396
MAIN - (765) 284-0694
TOLL FREE (800) 730-1906 FAX - (765) 284-2689

OWNER:
ALL STEEL CARPORTS

LOCATION: OHIO

DRAWING NO.: ASC-12

DATE: 11/23/2010

PROJECT NUMBER:
034-10-0981

DRAWN BY: JMS

CHECKED BY: OA

DRAWING TITLE:
**ANCHOR OPTION
PIER FOOTER**

SHEET NO.: 9 OF 9

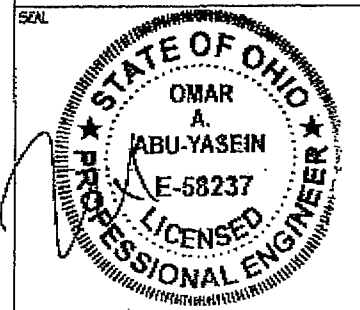

DATE SIGNED: 1/19/2011

18/ 31/ 2011 03:17 /692842689 ALL SITE PAGE 11/13



A & A ENGINEERING
 CIVIL • STRUCTURAL
 SINCE 1978

5911 Renaissance Pl., Suite B Toledo, Ohio 43623
 Tel: (419) 292-1983 Fax: (419) 292-0955

FOR:
ALL STEEL CARPORTS INC.
 LOCATION ADDRESS: 908 S. MOUND ST. #3
 MUNCIE, IN 47302
 MAILING ADDRESS: P.O. BOX 187
 YORKTOWN, IN 47396
 MAIN - (765) 284-0694
 TOLL FREE (800) 730-1906 FAX - (765) 284-2689

OWNER:
ALL STEEL CARPORTS

LOCATION: OHIO

DRAWING NO.: ASC-12

DATE: 11/23/2010

PROJECT NUMBER:
 034-10-0981

DRAWN BY: JMS

CHECKED BY: OA

DRAWING TITLE:
CONC. SLAB ANCHORAGE

SHEET NO.: 9 OF 9

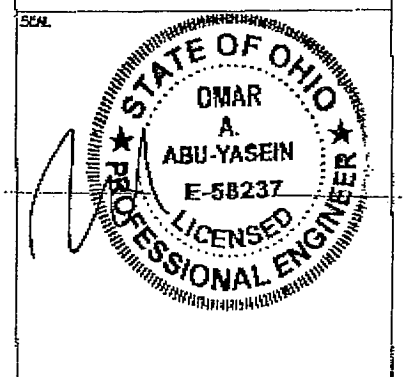

DATE SIGNED: 1/19/2011

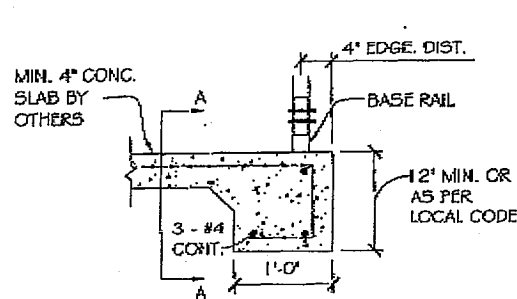

BASE ANCHOR ON CONC. SLAB SECTION

(SCALE: NTS)

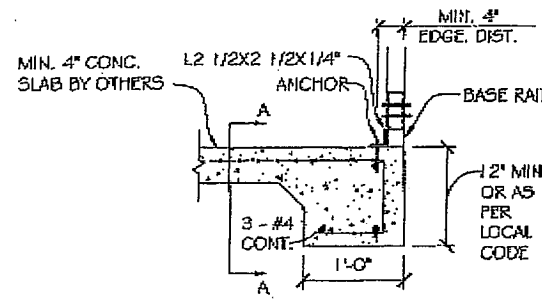

ALTERNATE, FRAME FLUSH W/ CONC.

(SCALE: NTS)

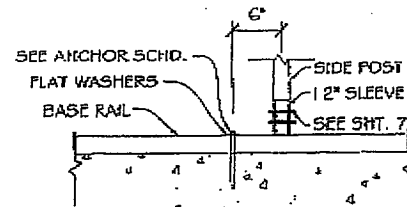

CONC. SLAB OR FOOTER W/ MIN. 12" WIDE X DEPTH AS PER LOCAL CODE (12" DEEP MIN.) RAT WALL ALL AROUND (BY OTHERS)

SECTION A-A

(SCALE: NTS)

ANCHOR SIZE OPTIONS SCHEDULE

	WIND SPEED (MPH)	BASE ANCHOR	ALTERNATE ANCHOR	REMARKS	CARPORT WIDTH
	90 - 100				
1	5/8"	7"	5"	INSERT W/ EPOXY IN CONC.	ALL SIZES
2	5/8"	7"	5"	EXPANSION BOLTS	ALL SIZES
3	5/8"	7"	5"	WEDGE ANCHORS IN CONC.	ALL SIZES

NOTE:

1. PROVIDE A MIN. OF (1) ANCHOR AT ±6" FROM CENTER OF EACH POST
2. ALL ANCHORS SHALL BE A307 OR BETTER
3. ASSUMED SOIL BEARING CAPACITY IS TO BE A MIN. 1500 PSF
4. CONCRETE STRENGTH TO BE A MIN. OF 2500 PSI AT 28 DAYS

10/31/2011 05:11 / 052842689 ALL STE PAGE 12/13

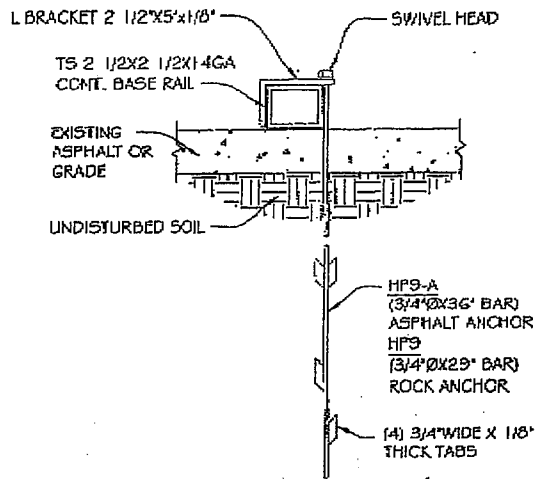

OPTIONAL ASPHALT/ ROCK ANCHOR DETAIL
(SCALE: NTS)

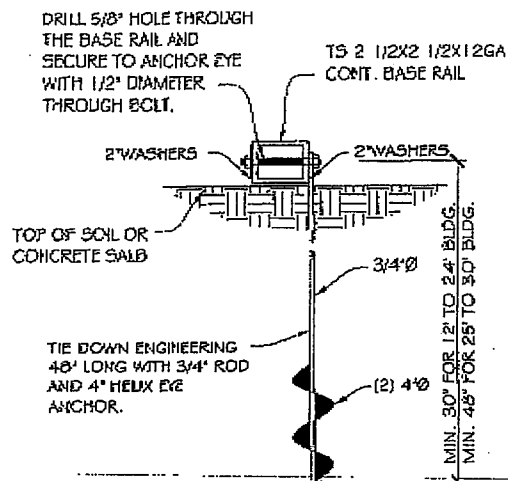

OPTIONAL MOBILE HOME ANCHOR FOR SAND/CLAY
(SCALE: NTS)

NOTE:
HELICAL ANCHORS ARE NOT TO BE USED IF DRIVING TORQUE INTO GROUND IS LESS THAN 150 FT-LBS OR DON'T MEET ONE OF THE FOLLOWING SOIL CLASSIFICATIONS.

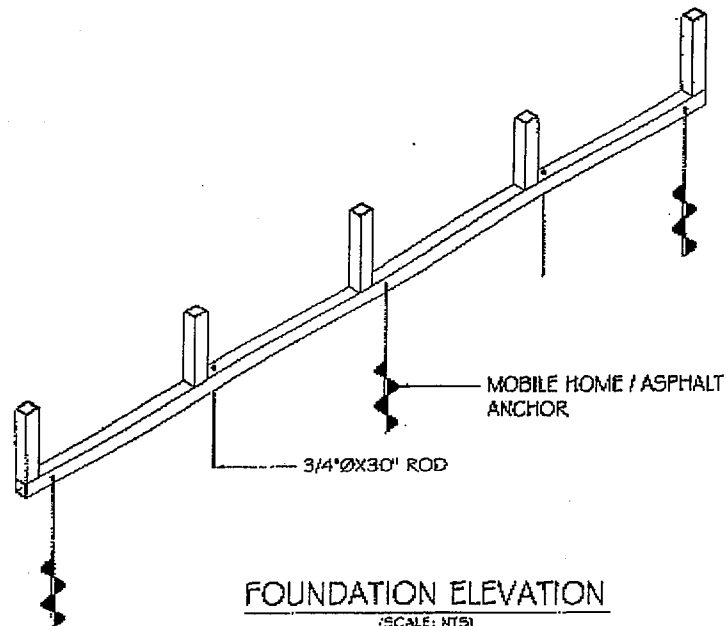

FOUNDATION ELEVATION
(SCALE: NTS)

- NOTES:**
1. MOBILE HOME ANCHORS SHALL BE REQUIRED AT ALL CORNER POSTS AND AT EVERY OTHER POST BUT SHALL NOT EXCEED 10-00C SPACING IN ANY DIRECTION.
 2. ALL OTHER POSTS WITH NO MOBILE HOME ANCHOR SHALL BE ANCHORED TO THE GROUND WITH 3/4x30LG. ROD. RODS SHALL HAVE A WELDED NUT AT TOP AND ONE COAT OF RUST PROVE PRIMER PAINT.
 3. ASSUMED SOIL BEARING CAPACITY IS TO BE A MIN. 1500 PSF

SOIL CLASSIFICATIONS:

SOIL CLASS	SOIL DESCRIPTION
2	VERY DENSE & / OR CEMENTED SANDS, COURSE GRAVEL AND COBBLES, COLICHE, PRELOADED SILT AND CLAYS
3	MEDIUM DENSE COARSE SANDS, SANDY GRAVELS, VERY STIFF SILTS, AND CLAYS
4	LOOSE TO MEDIUM DENSE SANDS, FIRM TO STIFF CLAYS AND SILTS ALLUVIAL FILL AND VERY LOOSE TO MEDIUM DENSE SANDS, FIRM TO STIFF CLAYS AND SILTS, ALLUVIAL FILL

HELICAL ANCHOR SHALL BE APPROVED FOR USE IN SOIL CLASSIFICATIONS 2,3, AND 4.

*TAKEN FROM HUD *STANDARD FOR INSTALLATION OF MOBILE HOMES*



5911 Renaissance Pl., Suite B Toledo, Ohio 43623 Tel: (419) 292-1983 Fax: (419) 292-0955

FOR:
ALL STEEL CARPORTS INC.
LOCATION ADDRESS: 908 S. MOUND ST. #3 MUNCIE, IN 47302
MAILING ADDRESS: P.O. BOX 187 YORKTOWN, IN 47396
MAIN - (765) 284-0694
TOLL FREE (800) 730-7906 FAX - (765) 284-2689

OWNER:
ALL STEEL CARPORTS
LOCATION: OHIO
DRAWING NO.: ASC-12
DATE: 11/23/2010
PROJECT NUMBER: 034-10-0981
DRAWN BY: JMS
CHECKED BY: OA
DRAWING TITLE:
ANCHORAGE OPTION

SHEET NO.: 9 OF 9

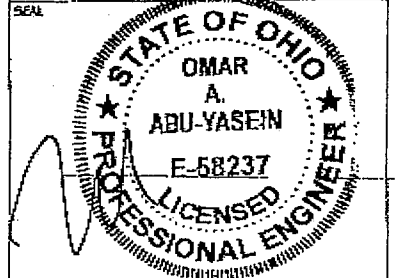

DATE SIGNED: 1/19/2011