

Lake Lure and the Blue Ridge Foothills Welcome Center



In 2012, the Town of Lake Lure and the Rutherford County Tourism Development Authority partnered to enhance the promotion of our tourism assets. This partnership has grown into a renovation project situated in the beautiful Hickory Nut Gorge.

The Lake Lure Welcome Center renovation project will begin in January 2013 and last a few short months. The Welcome Center will showcase the many experiences our visitors can find throughout Rutherford County, right here in our own back yard, the Hickory Nut Gorge.

During construction, we will have a temporary office and Welcome Center on site so that we may continue our Visitor Information Network (VIN) programming and assist our visitors in exploring our area.

Welcome Center
2932 Memorial Highway
Lake Lure, NC

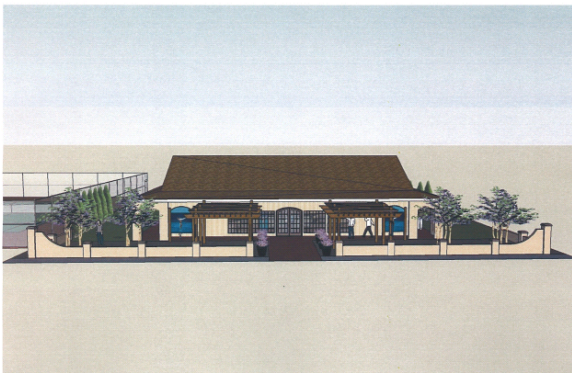

The Welcome Center will serve as an integral part of The Visitor Information Network.



Interior Rendering
Welcome Center Floor Plan

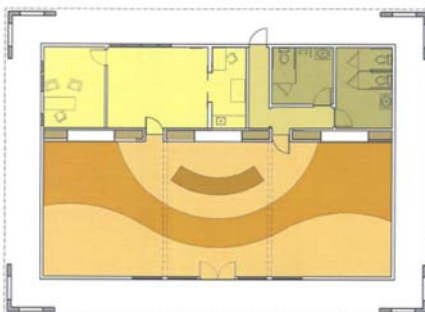

Visitors will have a convenient and comfortable place to relax and discover our diverse collection of tourism assets.

Stakeholders will find their business information showcased in a warm and inviting setting that is easily accessed, modern and flexible to meet the needs of all.

Interior Perspective
Welcome Center

A large, mixed media space will allow for creative and traditional means of communicating our information to our visitors, and provide great flexibility to stay current with how that information is shared to all who stop in to see us.

