

*A Grand City* on a CHARMING SCALE

Revenue Department

MEMORANDUM

DATE: June 20, 2012  
TO: Stacy Gilley  
Cc: Herman Marks, City Attorney  
FROM: Tina Boyles  
SUBJECT: Agenda Items for City Council

Please place the following items on the agenda for the City Council meeting, scheduled for July 02, 2012.

Let us know if you have any questions.

Thank You

1. *Man-Made Barrier* (Recommend Approval)  
(Gonzalez-Strength and Associates)

RESOLUTION NO. 12-204

**BE IT RESOLVED BY THE CITY COUNCIL OF THE CITY OF DECATUR, ALABAMA** that the application for consideration of a man-made barrier between the Ninth Street Methodist Church and a proposed grocery store be hereby approved.

READ, APPROVED AND ADOPTED this the 2<sup>nd</sup> day of July, 2012.



*A Grand City* on a CHARMING SCALE

**Revenue Department**

June 20, 2012

Honorable Mayor and City Council  
City of Decatur  
P.O. Box 488  
Decatur, AL 35602

RE: Man-made Barrier Request

Gentlemen:

The Alcohol Review Committee met and discussed a man-made barrier between the proposed grocery store and Ninth Street Methodist Church. The applicant submitted the attached drawing which also conforms to the City's landscape requirements. The Committee recommends the drawing for approval by the City Council.

If you have any questions concerning this request, please contact the City Revenue Department.

Very truly yours,

Tina Boyles, Revenue Supervisor

Cc: Herman Marks, City Attorney



# SUBDIVISION PLAT NEIGHBORHOOD MARKET

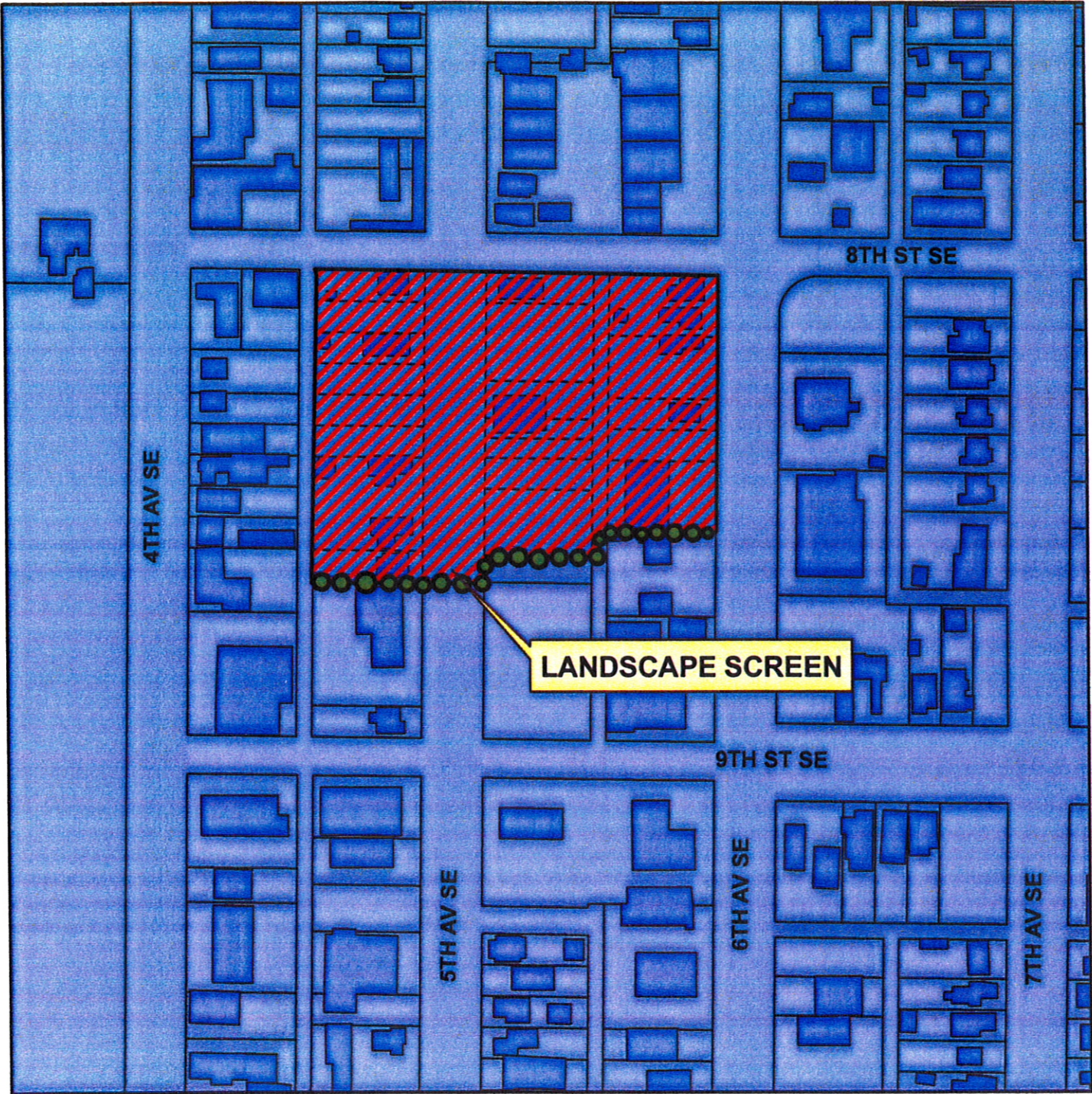

## Legend



bldg



corplim



SUBJECT PROPERTY

## LOCATION MAP

PREPARED BY THE CITY OF DECATUR  
PLANNING DEPARTMENT



APPLICANT: GONZALEZ- STRENGTH AND ASSOCIATES

DRAWING NOT TO SCALE

**ZONED RD**

Note: Every reasonable efforts has been made to assure the accuracy of this map. The City of Decatur does not assume liability arising from the use of this map. This map is provided without warranty of any kind, either expressed or implied.



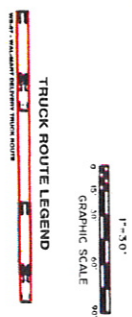
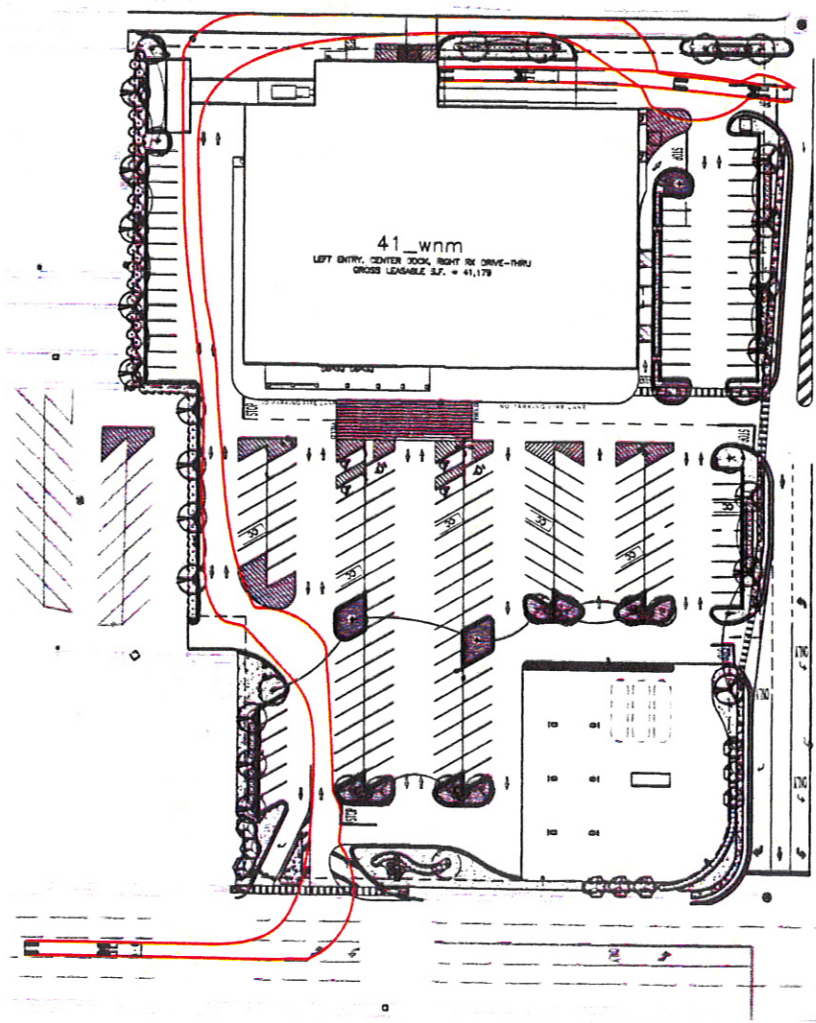
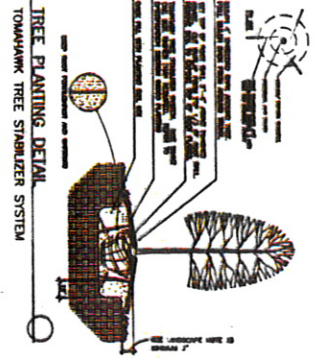

LANDSCAPE PLAN  
 NEIGHBORHOOD MARKET #04900-00  
 DECATUR, MORGAN COUNTY, ALABAMA  
 WAL-MART STORES, INC.  
 2201 SE 10TH STREET  
 BENTONVILLE, AR 72716

GONZALEZ • STRENGTH & ASSOCIATES, INC.  
 CIVIL ENGINEERING, LAND SURVEYING, PLANNING, TRAFFIC & TRANSPORTATION  
 1515 PARKWAY 1500 SUITE 100  
 BENTONVILLE, AR 72716  
 (479) 251-1515  
 www.gsa-engineers.com

| REVISIONS | BY |
|-----------|----|
|           |    |
|           |    |
|           |    |
|           |    |
|           |    |
|           |    |
|           |    |
|           |    |
|           |    |

|      |          |
|------|----------|
| DATE | 05/07/21 |
| BY   | LM       |
| CHK  | LM       |
| APP  | LM       |
| DATE | 05/07/21 |
| BY   | LM       |
| CHK  | LM       |
| APP  | LM       |





19 June 2012

Ms. Karen Smith  
City of Decatur Planning Department  
308 Cain Street, N. E.  
Decatur, Alabama 35601

Re: Ninth Street United Methodist Church  
Letter of Concurrence with Proposed Landscape Buffer for Adjoining Development  
Decatur, Alabama

Dear Ms. Smith:

As per our email communication, Ninth Street Methodist Church has reviewed the Landscape Buffer Plan that was submitted to our church by Mr. John Abernathy of Blackwater Resources this past month. The Trustee's committee reviewed the subject plan and found that it was suitable for the proposed buffer that is located on the common property lines between the proposed development and the church.

To this end, I was authorized by the Trustee's Committee to prepare this letter of concurrence with the proposed buffer improvements. Please note, should there be any changes to this plan, the Trustee's Committee reserves the right to review and approve any variances from the original buffer improvement plan.

If you should require any additional information or clarification of this transmittal, please don't hesitate to contact the church office or my office.

Sincerely,  
Ninth Street Methodist Church



Ronald Stroup  
Chairman of the Board of Trustees  
Ninth Street United Methodist Church