

# Landscape Buffering Requirements

## Northern Buffer

- Existing Vegetation will not be disturbed.

## Eastern Buffer

- Existing Vegetation will not be disturbed.

## Streetscape Buffer

- (28) October Glory Maple Trees
- (48) Green Gem Boxwood Shrubs
- (160) Stella de Oro Daylily
- (2) Retail Trees/Plants Heel In Bed Locations (17,300 square feet)

\* All Landscape beds to be completed with 2" minimum Dark Hardwood Mulch Materials.

Auditors Parcel  
510-0440-0103  
Becker, Kerry J. & Dorena L.  
O.R. 9967, Pg. 653

Auditors Parcel  
510-0440-0053  
Bears, James & Erma  
O.R. 8394, Pg. 1508

Auditors Parcel  
510-0440-0344  
Loeb, Stephen  
O.R. 11472, Pg. 2077

Auditors Parcel  
510-0440-0343  
Loeb, Stephen  
O.R. 11472, Pg. 2077

Auditors Parcel  
510-0440-0268  
Board of Hamilton  
County Commissioners

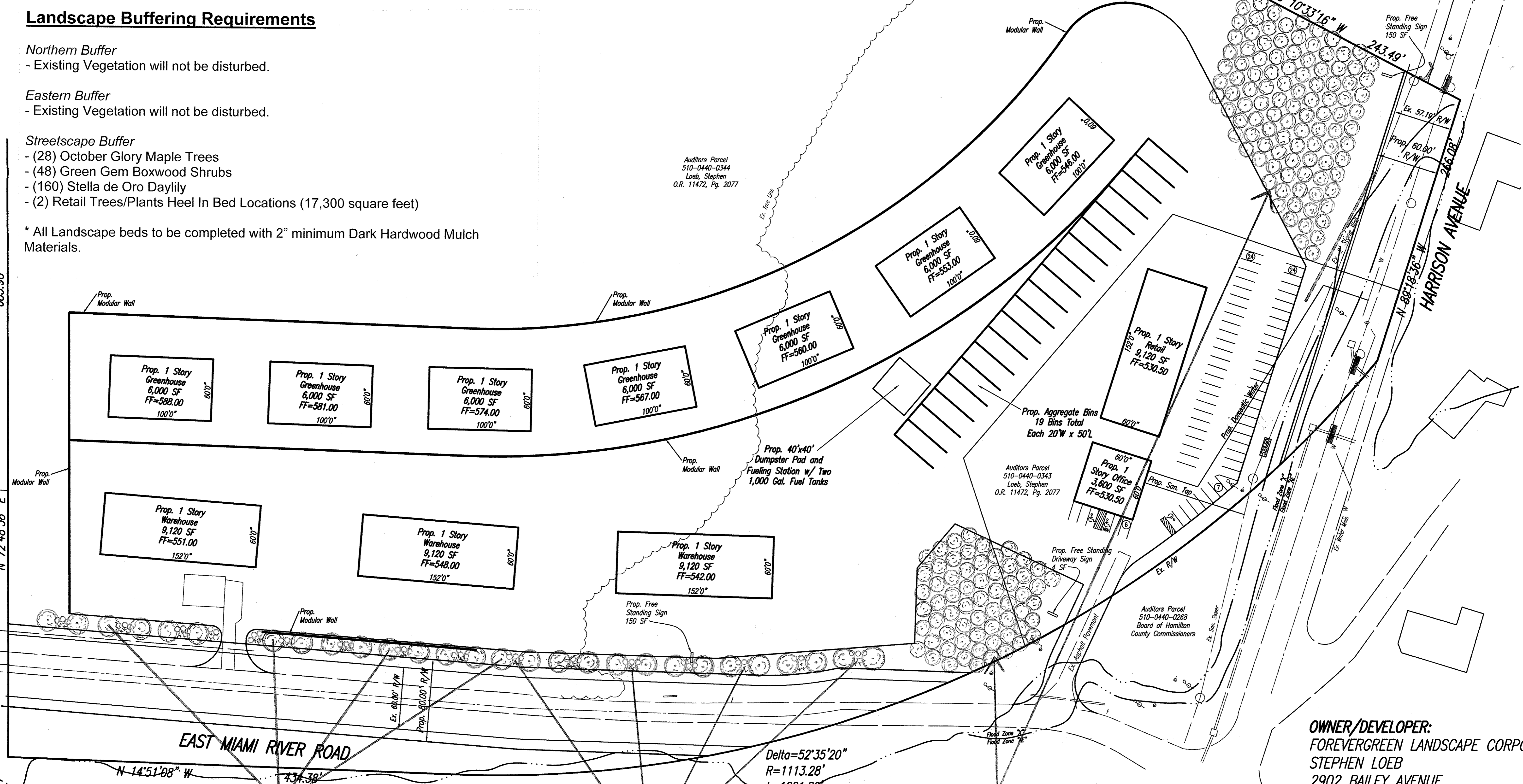

**Streetscape Buffer Trees**  
- 2.5" Caliper October Glory Maple Trees  
(30' spacing - 28 Trees Over 840 lineal feet)

**Streetscape Buffer Flowers/Shrubs/Color**  
- (16) Groupings of (3) 24" Green Gem Boxwoods, with front planting of (10) 1 gal. Stella Day Oro' Daylily Perennials, in 10'x10' sections (100 square foot area - 1,600 square feet).

**Retail Plants Heel In Beds**  
- Harrison Avenue Green Space Location  
120'x80' - 9,600 square feet  
  
- East Miami River Road Green Space Location  
100'x77' - 7,700 square feet

**Plant Key**

Symbol	Plant Common Name	Plant Botanical Name	Size
	October Glory Maple	Acer 'Rubrum'	2.5"
	Green Gem Boxwood	Buxus 'Green Gem'	24"-30"
	Stella Daylily	Hemerocallis 'Stella de Oro'	1 gal.
	Nursery Trees/Plants	Various	Various

**OWNER/DEVELOPER:**  
FOREVERGREEN LANDSCAPE CORPORATION  
STEPHEN LOEB  
2902 BAILEY AVENUE  
CINCINNATI, OHIO 45248  
513-451-8003

**"LANDSCAPE PLAN"**

**PARCEL I.D.:**  
510-0440-0343-00  
510-0440-0344-00

**DATE:**  
9/01/10

**SCALE:**  
1"=47'-0"

**SHEET NUMBER:**  
NP.1

