

PANEL MP					
CIRC.	LOCATION	AMP	CIRC.	LOCATION	AMP
1	FCU 1	2P	2	FCU 2	2P
3	FCU 1	50	4	FCU 2	50
5	HP 1	2P	6	HP 2	2P
7	HP 1	30	8	HP 2	30
9	RANGE	2P	10	WATER HEATER	2P
11	RANGE	50	12	WATER HEATER	30
13	LGTS - MECH. RR. HALL, STOR. OS FLOODS	20	14	LGTS - EXERCISE RM, ENTRY, KITCHEN, EF	20
15	LGTS & CLG FANS - GREAT ROOM	20	16	LGTS - GREAT ROOM	20
17	LGTS - SOFFIT (THRU PHOTO CELL)	20	18	WATER COOLER	20
19	REFRIGERATOR	20	20	RECEPS - KITCHEN	20
21	RECEPS - MICROWAVE	20	22	RECEPS - KITCHEN	20
23	RECEPS - EXERCISE RM, ENTRY	20	24	RECEPS - ENTRY, GREAT ROOM, OS GFI	20
25	RECEPS - EXERCISE RM, MECH RM	20	26	RECEPS - EXERCISE RM, MECH RRS	20
27	RECEPS - GARET ROOM, STOR	20	28	GARBAGE DISPOSAL	20
29	EXIT & EMERGENCY LIGHTS	20	30	HOOD ABOVE STOVE	20
31			32		
33			34		
35			36		
37			38		
39			40		
41			42		

LIGHTING FIXTURE SCHEDULE			
TYPE	MANUFACTURER OR APPROVED EQUAL	CATALOG NO.	REMARKS
A	RECESSED CAN LIGHT	R-1700R/ANC	6" CAN LIGHT
B	RECESSED CAN LIGHT	NL788R-6	3-LIGHT FLUORESCENT W/8" TB 18WV
C	RECESSED CAN LIGHT	66976	DUPLEX LIGHTS
D	EXIT SIGNATURE	180 2	A-6600/CL/EM 120 V (60/30)
E	EMERGENCY LIGHTS	180 2	A-6600/CL/EM 120 V (60/30)
F	FLUORESCENT	180 2	S-4 WATT
X-1	EXIT LIGHT	180 2	C-150R/88
X-2	EXIT LIGHT	180 2	LED
		180 2	10 LED (10 3 WATT)
		180 2	RED LETTERS/WHITE FACE
		180 2	RED LETTERS/WHITE FACE

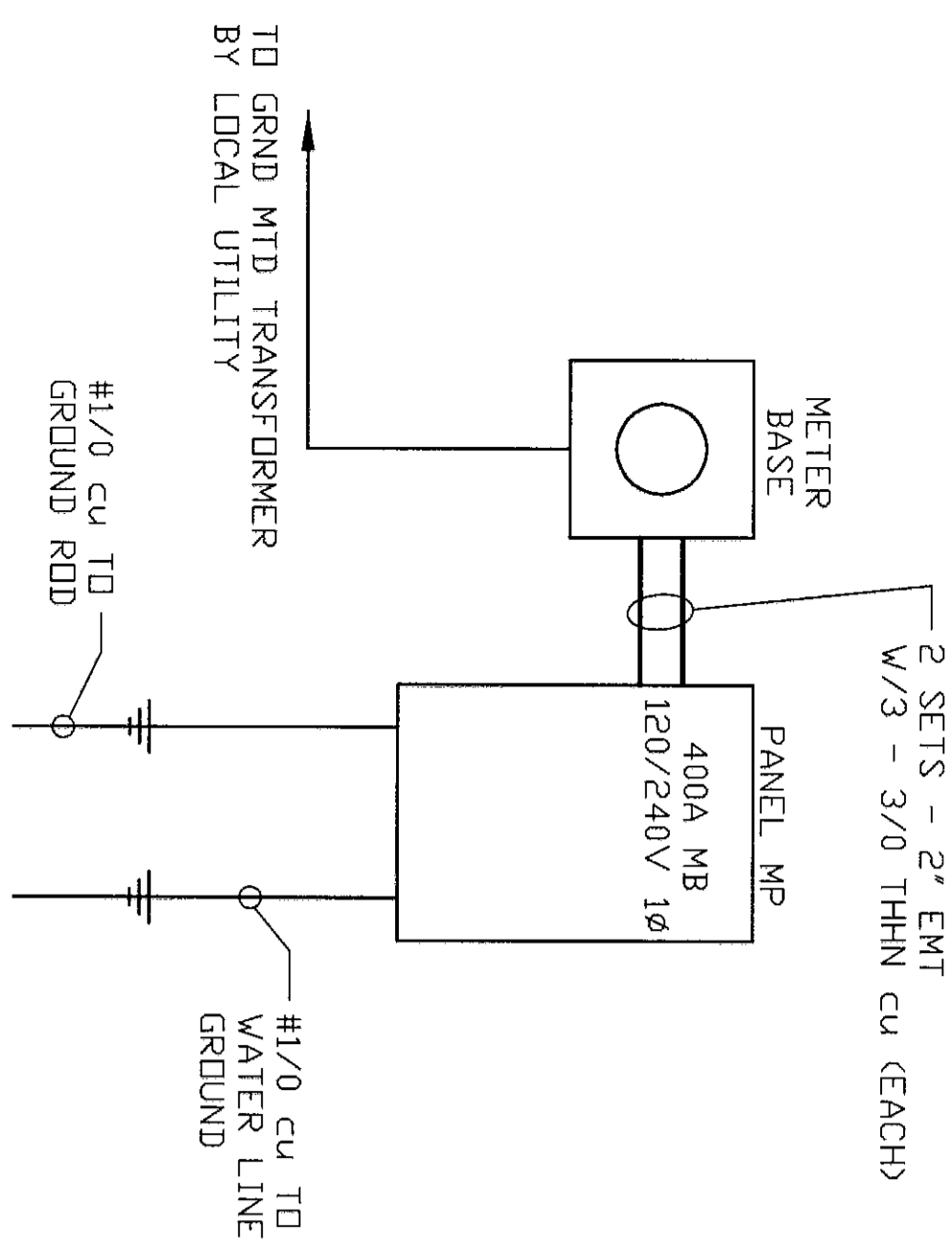

RISER DETAIL  
SCALE: NONE

**MOUNTING HEIGHTS FOR ELECTRICAL ITEMS**

The mounting heights listed are standards for the items listed below, unless noted otherwise on plans. If mounting items at these heights causes interference with other items, or is a specialty item or an item is not listed, contact the engineer for a clarification.

- \* Receptacles at Walls: Bottom of receptacle 16" A.F.F. (to meet ADA requirements) unless noted otherwise.
- \* Receptacles at Counter Tops: Bottom of receptacle coverplate 1' above backsplash unless specified otherwise.
- \* Light Switches: Top of box 48" A.F.F. (to meet ADA requirements).
- \* Office Area - Strobe Lights, Alarm Horns & Emergency Lights: Bottom of fixture 1'-0" below ceiling line (must meet ADA requirements: bottom of fixture not less than 6'-8" A.F.F. and not greater than 8'-0" A.F.F.)
- \* Industrial/Garage/Warehouse Areas - Strobe Lights, Alarm Horns, Emergency Lights and Sound System: Bottom of fixture 12'-0" A.F.F.
- \* Wall Mounted Exit Lights: Bottom of fixture at 1' above door frame/casing.
- \* Electric Panels: Top of panel 6'-6" A.F.F.
- \* Security Cameras and Equipment: As per manufacturer's recommendations.
- \* Thermostats: Centerline 54" A.F.F.
- \* Door Key Pads: Top of keypad 48" A.F.F.
- \* Volume Controls: Top of box 48" A.F.F.
- \* Disconnect for Overhead Doors: Surface mount, at equipment.
- \* Pushbuttons for Overhead Doors: Surface mount, 48" A.F.F. to top of box.
- \* Fire Alarm Control Panel: As per manufacturer's recommendations and ADA requirements (zone expander module to be mounted in fire alarm panel).
- \* Exterior Wall Pack Lighting: Top of fixture 1'-0" below gutter at eaves, continue at same height around building.

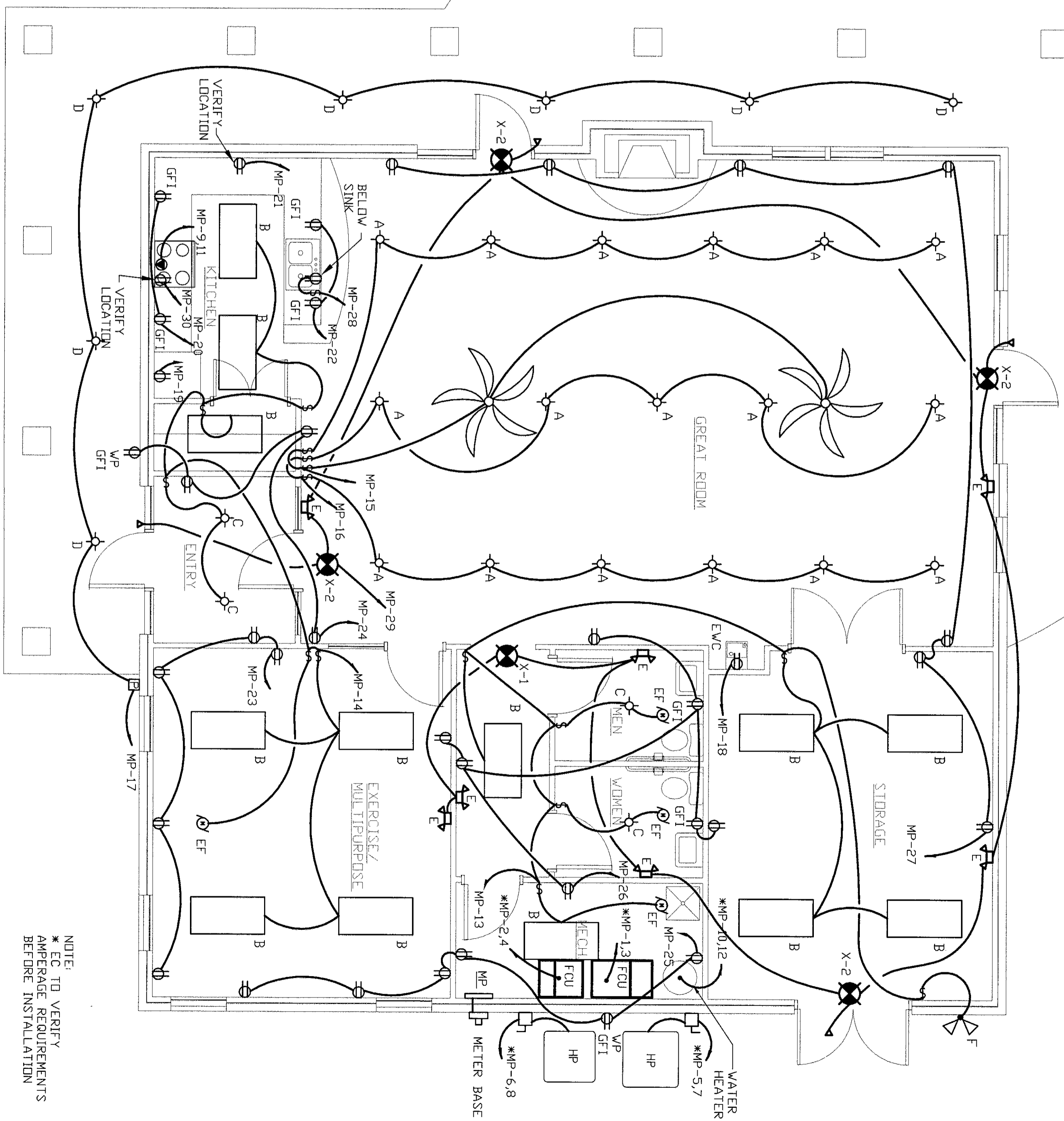

FLOOR PLAN - ELECTRICAL  
SCALE: 1/4" = 1'-0"

NOTE:  
\* EC TO VERIFY  
AMPERAGE REQUIREMENTS  
BEFORE INSTALLATION

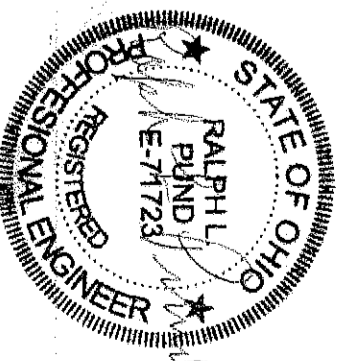

TRILOGY HEALTH SERVICES 11230 PIPPIN RD. CINCINNATI, OH				910 Main Street Ferdinand, IN 47532 Phone: 812/357-2831 Fax: 812/367-2401 design@uddassoc.com	<small>This drawing is the property of Universal Design Associates, Inc. (UDA). Any reproduction, whether partial or full, shall not be made without the express written consent of an authorized representative of UDA. Any review or verification or adaptation by Universal shall be at the owner's sole risk and without liability or responsibility to UDA. Any deviation in the work or omission from UDA's governing code requirements is not intended and shall not constitute contractor responsibility to obtain local requirements. These documents were prepared in accordance with the best professional practice possible, in good faith, and are furnished in the best professional practice possible. It is the policy of UDA, Inc. that UDA shall not be liable for any errors or omissions in this drawing. Any deviation from these documents, without the written verification of UDA, Inc., shall release UDA of any liability resulting from the unauthorized deviation. Copyright 2000, Universal Design Associates, Inc.</small>
TRIOLOGY HEALTH CAMPUS COMMUNITY BUILDING 11230 PIPPIN RD. CINCINNATI, OH		DRAWN BY: AUJ CHECKED BY: RFP APPROVED: RFP 0669		DATE: 12-18-07 COMMUNITY BLDG ELECTRICAL PLAN E-10	