



# Will County Department of Highways

16841 W. LARAWAY ROAD  
JOLIET, ILLINOIS 60433  
(815) 727-8476  
FAX (815) 727-9806

**BRUCE D. GOULD, PE**  
COUNTY ENGINEER

April 25, 2011

Mr. Tim Schloneger  
Administrator  
City of Lockport  
222 East Ninth Street  
Lockport, IL 60441

**Subject:** County Highway 62, Briggs Street  
Section Number 10-00150-14-BR  
Bridge over Spring Creek

Dear Mr. Schloneger:

Please be advised that the Will County Department of Highways has awarded a contract to replace the Briggs Street bridge over Spring Creek, located north of US Route 6. The project schedule anticipates construction activities to begin July 5, 2011 and continue through November 25, 2011. Briggs Street will be closed to traffic during the term of construction to facilitate removal and replacement of the structure. A Detour Plan is provided with this notification for your reference.

Thank You for your cooperation, if you have any questions or need additional information please call our office.

Sincerely,

Bruce D. Gould, P.E.  
County Engineer

By:

  
George R. Catalano, P.E.  
Assistant County Engineer

Enclosure

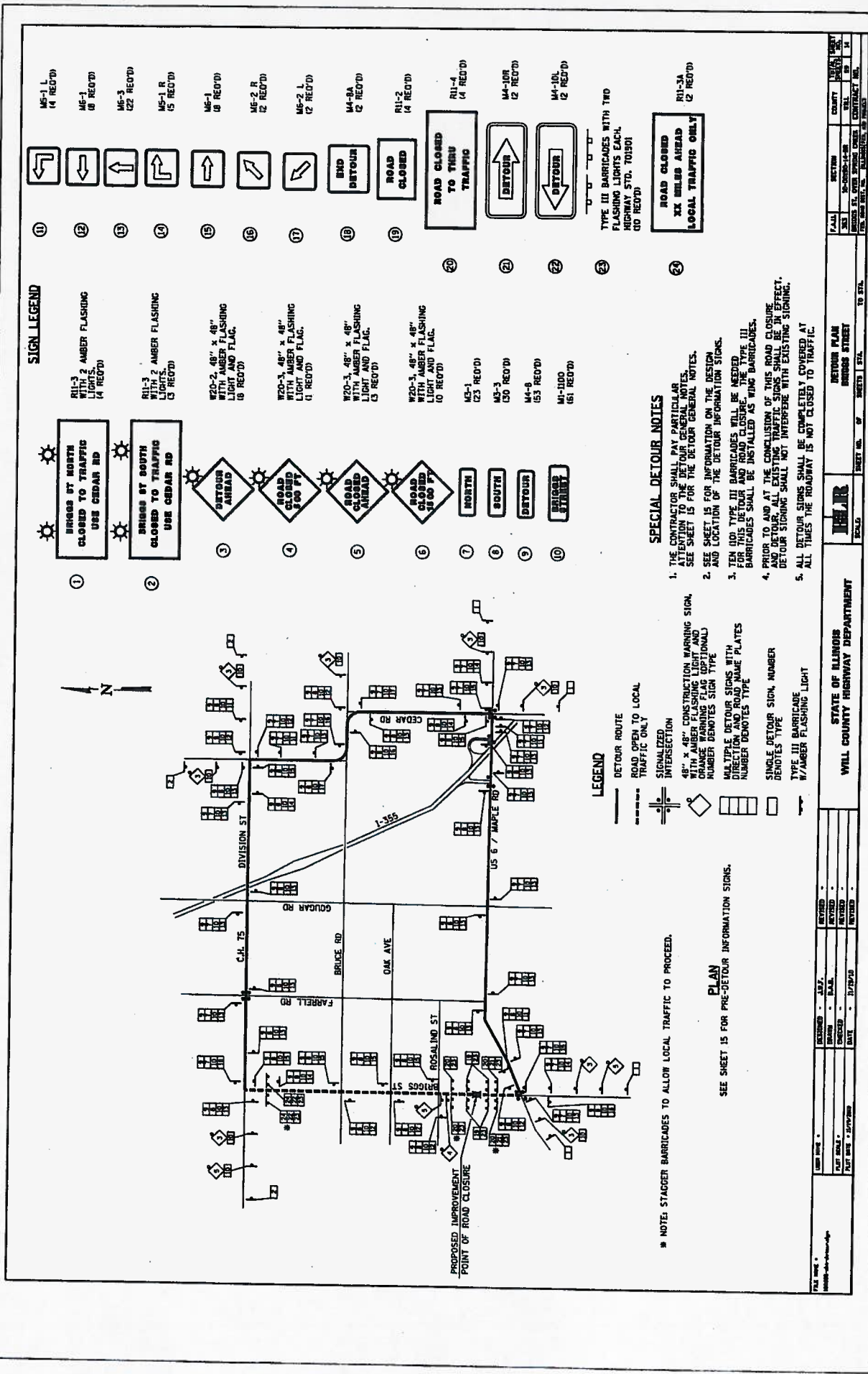

**SIGN LEGEND**

- 1. BRIGGS BY NORTH CLOSED TO TRAFFIC USE CEDAR RD. (Sign: M-101)
- 2. BRIGGS BY SOUTH CLOSED TO TRAFFIC USE CEDAR RD. (Sign: M-102)
- 3. DETOUR AHEAD. (Sign: W-20-1)
- 4. ROAD CLOSED 500 FT. (Sign: W-20-2)
- 5. ROAD CLOSED AHEAD. (Sign: W-20-3)
- 6. ROAD CLOSED 300 FT. (Sign: W-20-3)
- 7. NORTH. (Sign: M-5-1)
- 8. SOUTH. (Sign: M-5-3)
- 9. DETOUR. (Sign: M-4-8)
- 10. BRIGGS STREET. (Sign: M-4-100)
- 11. M-1 L (4 REQ'D)
- 12. M-1 (8 REQ'D)
- 13. M-3 (22 REQ'D)
- 14. M-1 R (5 REQ'D)
- 15. M-1 (8 REQ'D)
- 16. M-2 R (2 REQ'D)
- 17. M-2 L (2 REQ'D)
- 18. END DETOUR. (Sign: M-4-3A)
- 19. ROAD CLOSED. (Sign: R-1-2)
- 20. ROAD CLOSED TO THRU TRAFFIC. (Sign: R-1-4)
- 21. DETOUR. (Sign: M-4-10N)
- 22. DETOUR. (Sign: M-4-10L)
- 23. TYPE III BARRICADES WITH TWO FLASHING LIGHTS EACH HIGHWAY STD. 701001. (Sign: R-11-3A)
- 24. ROAD CLOSED XX MILES AHEAD LOCAL TRAFFIC ONLY. (Sign: R-11-3A)

**SPECIAL DETOUR NOTES**

- THE CONTRACTOR SHALL PAY PARTICULAR ATTENTION TO THE DETOUR GENERAL NOTES. SEE SHEET 15 FOR THE DETOUR GENERAL NOTES.
- SEE SHEET 15 FOR INFORMATION ON THE DESIGN AND LOCATION OF THE DETOUR INFORMATION SIGNS.
- TEN (10) TYPE III BARRICADES WILL BE NEEDED FOR THIS DETOUR AND ROAD CLOSURE. BARRICADES SHALL BE INSTALLED AS WING BARRICADES.
- PRIOR TO AND AT THE CONCLUSION OF THIS ROAD CLOSURE AND DETOUR, ALL EXISTING TRAFFIC SIGNS SHALL BE RE-EVALUATED AND DETOUR SIGNING SHALL NOT INTERFERE WITH EXISTING SIGNING.
- ALL DETOUR SIGNS SHALL BE COMPLETELY COVERED AT ALL TIMES THE ROADWAY IS NOT CLOSED TO TRAFFIC.

**LEGEND**

- DETOUR ROUTE
- ROAD OPEN TO LOCAL TRAFFIC ONLY
- SIGNALIZED INTERSECTION
- 48" x 48" CONSTRUCTION WARNING SIGN WITH AMBER FLASHING LIGHT AND ORANGE WARNING FLAG (OPTIONAL)
- MULTIPLE DETOUR SIGNS WITH DIRECTION AND ROAD NAME PLATES NUMBER DENOTES TYPE
- SINGLE DETOUR SIGN, NUMBER DENOTES TYPE
- TYPE III BARRICADE
- W/AMBER FLASHING LIGHT

**PLAN**

SEE SHEET 15 FOR PRE-DETOUR INFORMATION SIGNS.

NOTE: STAGGER BARRICADES TO ALLOW LOCAL TRAFFIC TO PROCEED.

DATE: 10/1/01	DESIGNED: J.S.Z.	CHECKED: J.S.Z.	IN CHARGE: J.S.Z.
DATE: 10/1/01	DESIGNED: B.A.A.	CHECKED: B.A.A.	IN CHARGE: B.A.A.
DATE: 10/1/01	DESIGNED: J.P.G.	CHECKED: J.P.G.	IN CHARGE: J.P.G.
DATE: 10/1/01	DESIGNED: M.T.	CHECKED: M.T.	IN CHARGE: M.T.

STATE OF MICHIGAN	WILL COUNTY HIGHWAY DEPARTMENT
BRIGGS ST. OVER BRIGGS CREEK	BRIGGS STREET
SECTION 14-000-14-00	SECTION 14-000-14-00
CONTRACT NO. 01-0000000000	CONTRACT NO. 01-0000000000
SHEET NO. 1	SHEET NO. 1
OF 1	OF 1