

City of Euclid Council Ward Redistricting

Presented to the

City of Euclid Council

By

Mark Salling, PhD, GISP

October 20, 2021

(With corrections)

1

Ohio Secretary of State

**ADVISORY 2021-04
September 16, 2021**

**To: All County Boards of Elections
Board Members, Directors, and Deputy Directors**

Re: Results and Impact of 2020 Federal Decennial Census

VI. CITY WARDS

According to R.C. 731.06, the legislative authority of a city is responsible for subdividing the city into wards within 90 days after the first day of October following the federal decennial census year. Questions about dividing a city into wards should be directed to the city law director or the legislative authority of the city.

<https://www.ohiosos.gov/globalassets/elections/advisories/2021/adv2021-04.pdf>

2

City Charter

Within sixty days after the proclamation of the Secretary of State announcing the population of cities of Ohio, as determined by the Federal census decennially taken, ...

the Council shall re-divide the City into eight wards...

which shall be as nearly equal in population as is possible, each composed of contiguous and compact territory bounded by natural boundaries or street lines.

Upon failure of the Council to redivide the City within the period provided, the Director of Law shall redivide it as herein provided and he shall file such plan with the Clerk of Council. This plan shall thereupon become the new division by ward of the City.

https://codelibrary.amlegal.com/codes/euclid/latest/euclid_oh/0-0-0-129#JD_Art.IISec.2

3

Redistricting Rules and Guides

Population Equality

Contiguity

Compactness

Communities of Interest

Representational Fairness (Proportionality)

Competitiveness

AND...

4

The Voting Rights Act of 1965

Guidance under Section 2 of the Voting Rights Act, 52 U.S.C. 10301, for redistricting and methods of electing government bodies

Published September 1, 2021

U.S. Department of Justice

Section 2 of the Voting Rights Act prohibits discrimination in voting on the basis of race, color, or membership in a language minority group. This permanent, nationwide prohibition applies to any voting qualification or prerequisite to voting or standard, practice, or procedure, **including districting plans** and methods of election for governmental bodies.

States and **political subdivisions** should take the Voting Rights Act's requirements into account when redrawing electoral maps, altering a method of election, or maintaining a method of election that could have the potential to discriminate.

5

Redistricting Data

Decennial Census

Population by Race/Hispanic Ethnicity
and Voting Age

Possibly...

Other Demographic Data
Recent Election Data

Geography

(the "building blocks")

Census Blocks

Other geographic Features

6

Current Wards

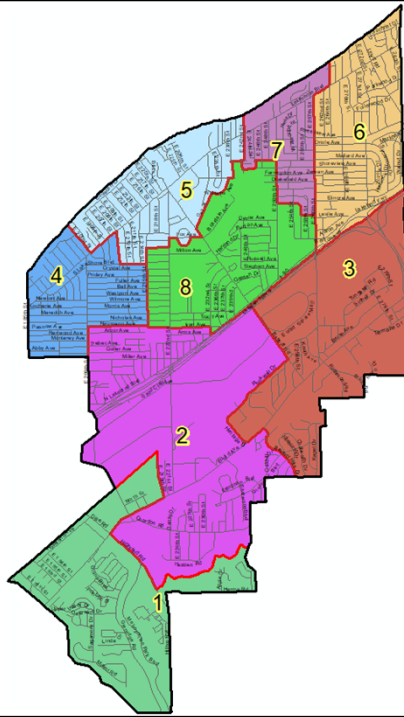

7

Census Block Populations

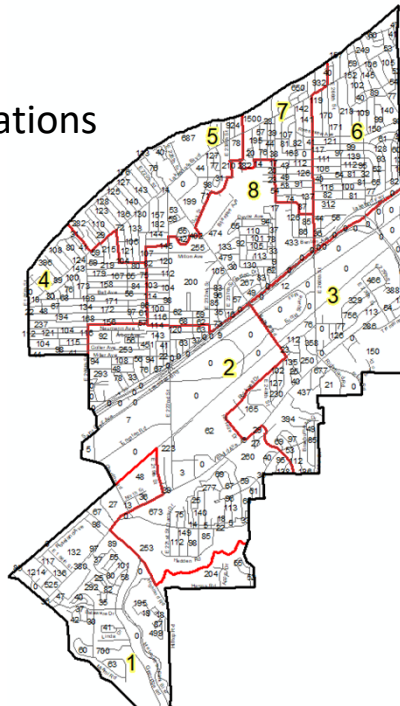

8

Does the City need to redraw its wards?

9

What is the distribution of population by Ward according to the 2020 Census?

Ward	Population	White alone	Black or African American alone	American Indian and Alaska Native alone	Asian alone	Native Hawaiian and Other Pacific Islander alone	Some Other Race alone	Population of two or more races	Black or African American, any combination	Hispanic / Latino
1	6,054	790	4,966	3	22	1	37	235	5,159	121
2	6,382	1,952	3,997	12	26	1	86	308	4,224	152
3	6,663	747	5,543	14	33	2	44	280	5,758	91
4	5,983	2,060	3,518	12	51	3	53	286	3,706	105
5	6,571	2,896	3,265	19	43	0	59	289	3,443	134
6	6,035	2,873	2,795	9	42	1	70	245	2,950	181
7	5,902	1,714	3,804	11	58	0	107	208	3,937	143
8	6,102	1,789	3,910	9	43	1	106	244	4,102	121
Total	49,692	14,821	31,798	89	318	9	562	2,095	33,279	1,048
Average	6,212	1,853	3,975	11	40	1	70	262	4,160	131

10

District Population Deviations

Ward	Population	Deviation	Percent Deviation
1	6,054	-158	-2.54%
2	6,382	171	2.74%
3	6,663	452	7.27%
4	5,983	-229	-3.68%
5	6,571	360	5.79%
6	6,035	-177	-2.84%
7	5,902	-310	-4.98%
8	6,102	-110	-1.76%
Total	49,692	0	0.00%
Average	6,212		
High	6,522		
Low	5,901		

The generally accepted rule is to allow less than a 5% deviation.

11

Percentage of Population

Ward	Population	White alone	Black or African American alone	American Indian and Alaska Native alone	Asian alone	Native Hawaiian and Other Pacific Islander alone	Some Other Race alone	Population of two or more races	Black or African American, any combination	Hispanic / Latino
1		13.0%	82.0%	0.0%	0.4%	0.0%	0.6%	3.9%	85.2%	2.0%
2		30.6%	62.6%	0.2%	0.4%	0.0%	1.3%	4.8%	66.2%	2.4%
3		11.2%	83.2%	0.2%	0.5%	0.0%	0.7%	4.2%	86.4%	1.4%
4		34.4%	58.8%	0.2%	0.9%	0.1%	0.9%	4.8%	61.9%	1.8%
5		44.1%	49.7%	0.3%	0.7%	0.0%	0.9%	4.4%	52.4%	2.0%
6		47.6%	46.3%	0.1%	0.7%	0.0%	1.2%	4.1%	48.9%	3.0%
7		29.0%	64.5%	0.2%	1.0%	0.0%	1.8%	3.5%	66.7%	2.4%
8		29.3%	64.1%	0.1%	0.7%	0.0%	1.7%	4.0%	67.2%	2.0%
Total		29.8%	64.0%	0.2%	0.6%	0.0%	1.1%	4.2%	67.0%	2.1%

12

Possible steps to put population back into balance

13

Corrections to Population Deviation Issue

Fixing Ward 7 with a block from Ward 5

$$78 + 5,902 = 5,980$$

Above the 5,901 minimum
and within the +- 5% population range

Ward	Population	Deviation	Percent Deviation
1	6,054	-158	-2.54%
2	6,382	171	2.74%
3	6,663	452	7.27%
4	5,983	-229	-3.68%
5	6,571	360	5.79%
6	6,035	-177	-2.84%
7	5,902	-310	-4.98%
8	6,102	-110	-1.76%
Total	49,692	0	0.00%
Average	6,212		
High	6,522		
Low	5,901		

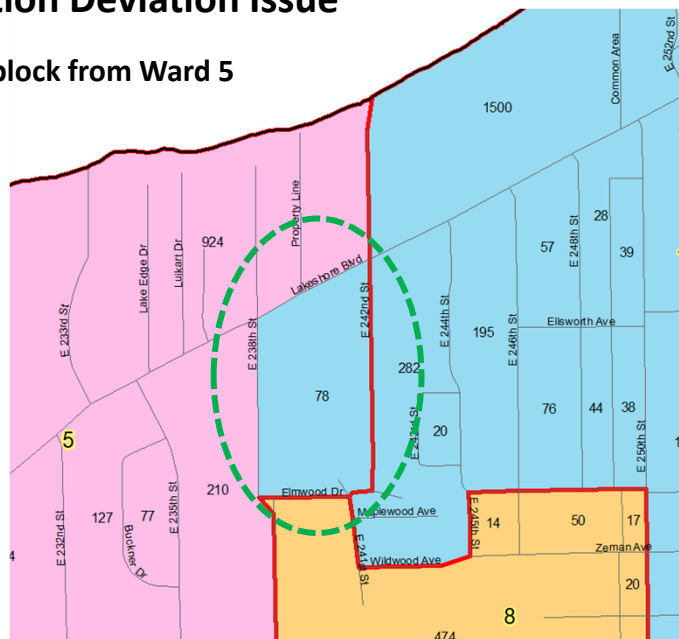

14

Fixing Ward 3 in 2 steps

Ward	Population	Deviation	Percent Deviation
1	6,054	-158	-2.54%
2	6,382	171	2.74%
3	6,663	452	7.27%
4	5,983	-229	-3.68%

1) move a block with 172 persons from Ward 2 to 4

2) to allow moving population from Ward 3 to Ward 2

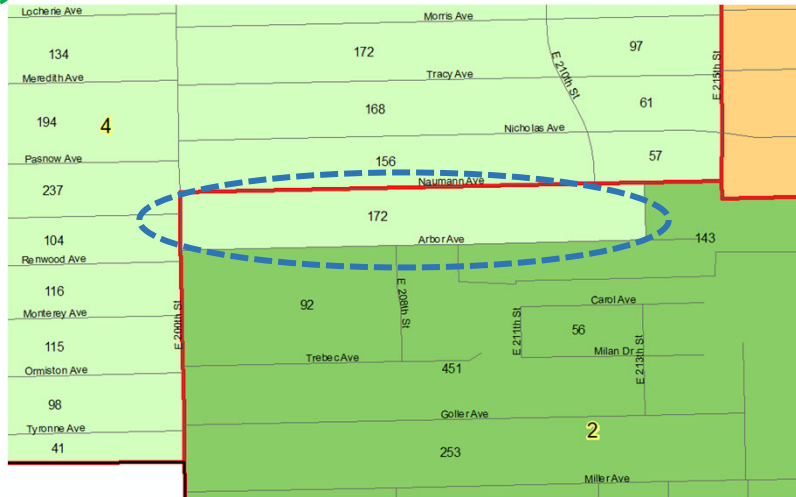

15

District Population Deviations

Ward	Population	Deviation	Percent Deviation
1	6,054	-158	-2.54%
2	6,382	171	2.74%
3	6,663	452	7.27%
4	5,983	-229	-3.68%
5	6,571	360	5.79%
6	6,035	-177	-2.84%
7	5,902	-310	-4.98%
8	6,102	-110	-1.76%
Total	49,692	0	0.00%
Average	6,212		
High	6,522		
Low	5,901		

We just moved 172 persons from Ward 2 to Ward 4.

Now we can move some persons from Ward 3 to Ward 2.

16

Fixing Ward 3

Step 2 --- either:

a) move two blocks with 165 persons from Ward 3 to 2;

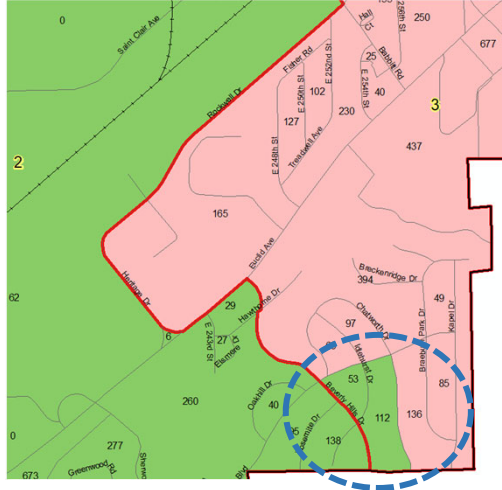

or

b) move one block with 165 persons from Ward 3 to Ward 2.

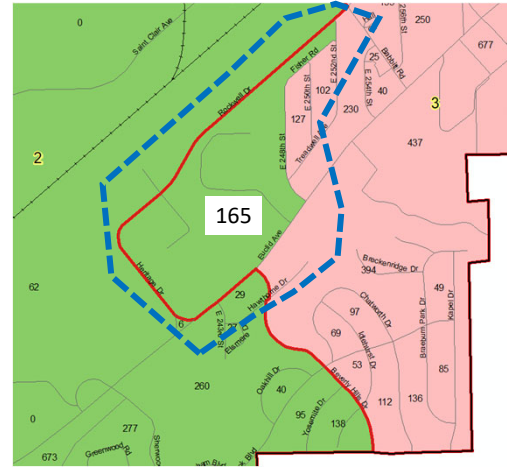

Therefore, $6,382 - 172 + 165 = 6,375$
Therefore, within the $\pm 5\%$ population range

17

Current Population Distribution

Ward	Population	Deviation	Percent Deviation
1	6,054	-158	-2.54%
2	6,382	171	2.74%
3	6,663	452	7.27%
4	5,983	-229	-3.68%
5	6,571	360	5.79%
6	6,035	-177	-2.84%
7	5,902	-310	-4.98%
8	6,102	-110	-1.76%
Total	49,692	0	0.00%
Average	6,212		
High	6,522		
Low	5,901		

Draft Plan Distribution

Ward	Population	Deviation	Percent Deviation
1	6,054	-158	-2.54%
2	6,375	164	2.63%
3	6,458	-267	-4.61%
4	6,155	-57	-0.91%
5	6,493	-282	-4.53%
6	6,035	-177	-2.84%
7	5,960	-232	-3.73%
8	6,102	-110	-1.76%
Total	49,692	0	0.00%

18

Draft Plan

2020 Population, Draft Euclid Wards

Ward	Population	White alone	Black or African American alone	American Indian and Alaska Native alone	Asian alone	Native Hawaiian and Other Pacific Islander alone	Some Other Race alone	Population of two or more races	Black or African American, any combination	Hispanic / Latino	Percent Deviation	Percent Deviation
1	6,054	790	4,966	3	22	1	37	235	5,159	121	-158	-2.54%
2	6,375	1,929	4,009	12	25	1	87	312	4,235	152	164	2.63%
3	6,498	693	5,443	14	32	2	41	273	5,656	83	287	4.61%
4	6,155	2,137	3,606	12	53	3	55	289	3,797	113	-57	-0.91%
5	6,493	2,873	3,213	19	43	0	58	287	3,389	133	282	4.53%
6	6,035	2,873	2,795	9	42	1	70	245	2,950	181	-177	-2.84%
7	5,980	1,737	3,856	11	58	0	108	210	3,991	144	-232	-3.73%
8	6,102	1,789	3,910	9	43	1	106	244	4,102	121	-110	-1.76%
Total	49,692	14,821	31,798	89	318	9	562	2,095	33,279	1,048	0	0.00%
Average	6,212	1,853	3,975	11	40	1	70	262	4,160	131		
High	6,522											
Low	5,901											

19

Questions/Discussion

20